

ISOILLE KAPPALEILLE

**FAST[®]
MILL**

FASTMILL.IT

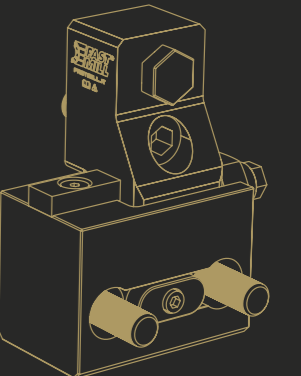

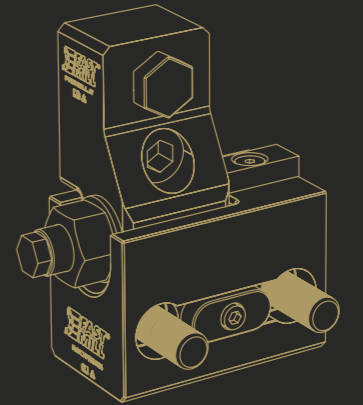
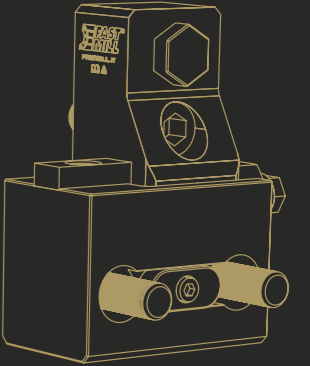
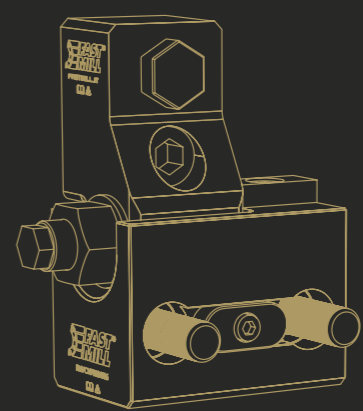
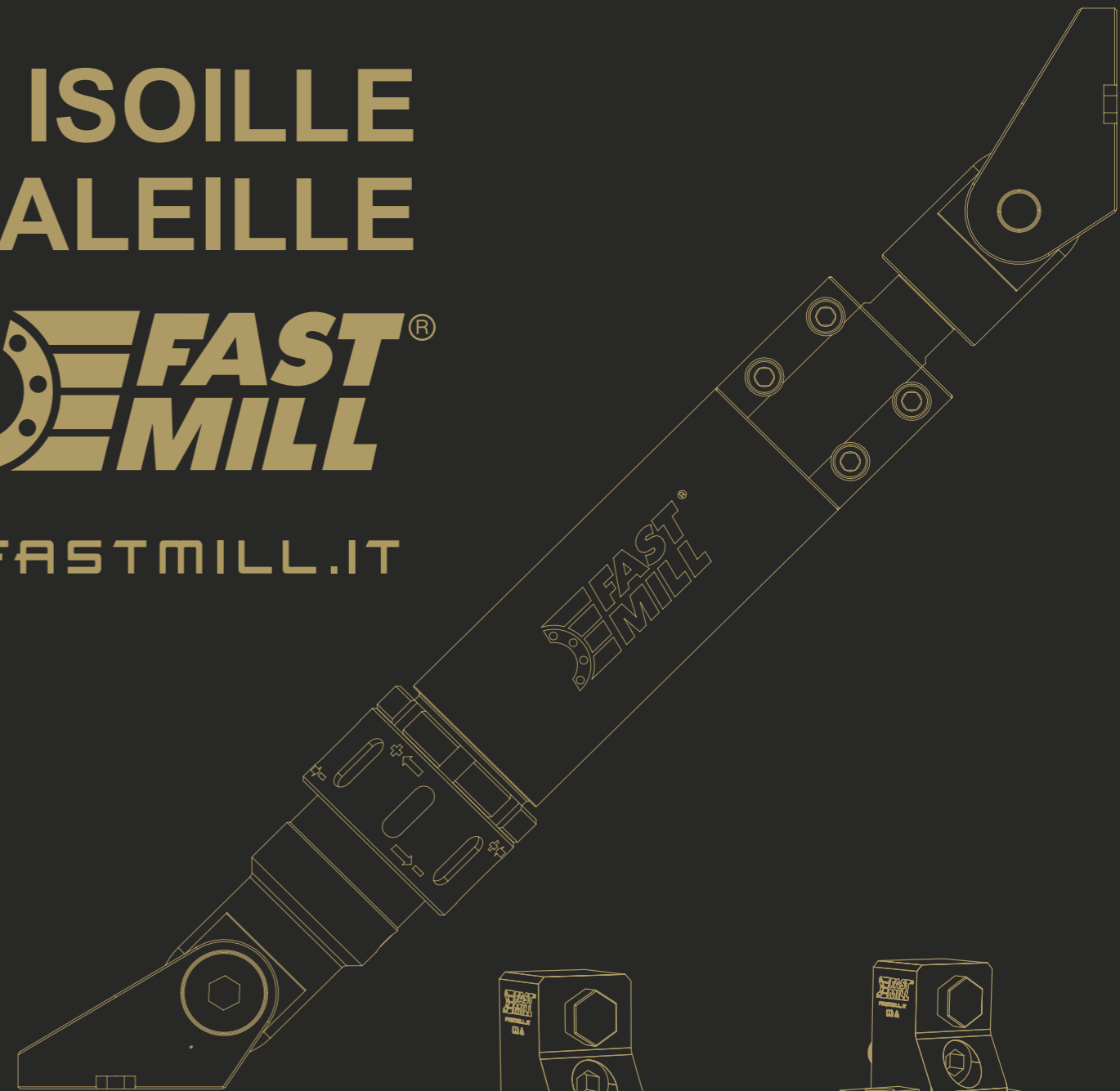
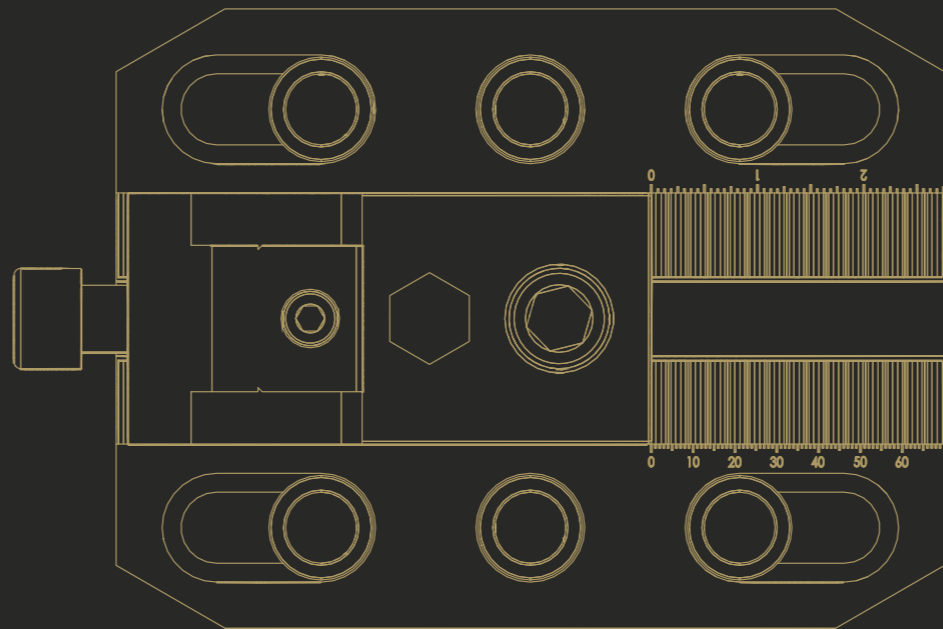
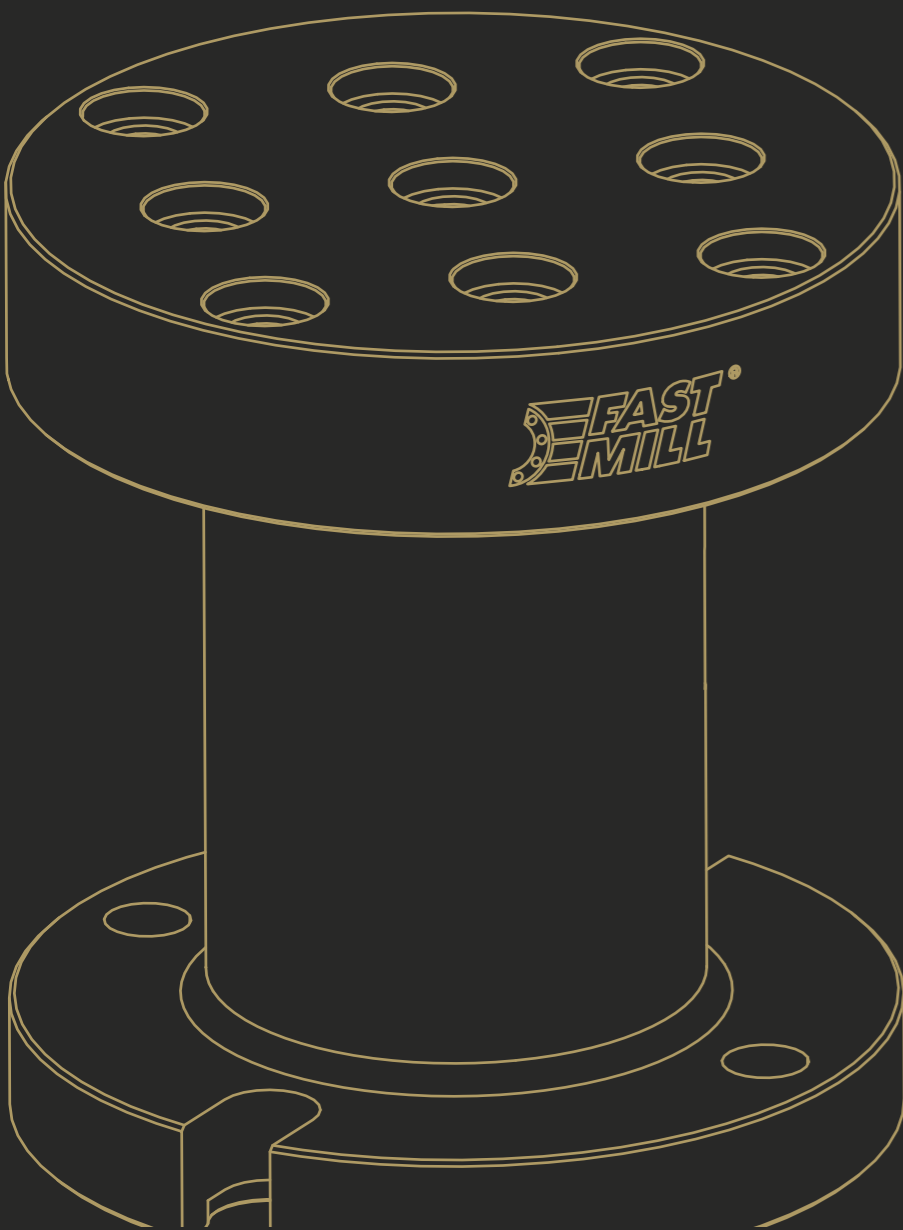
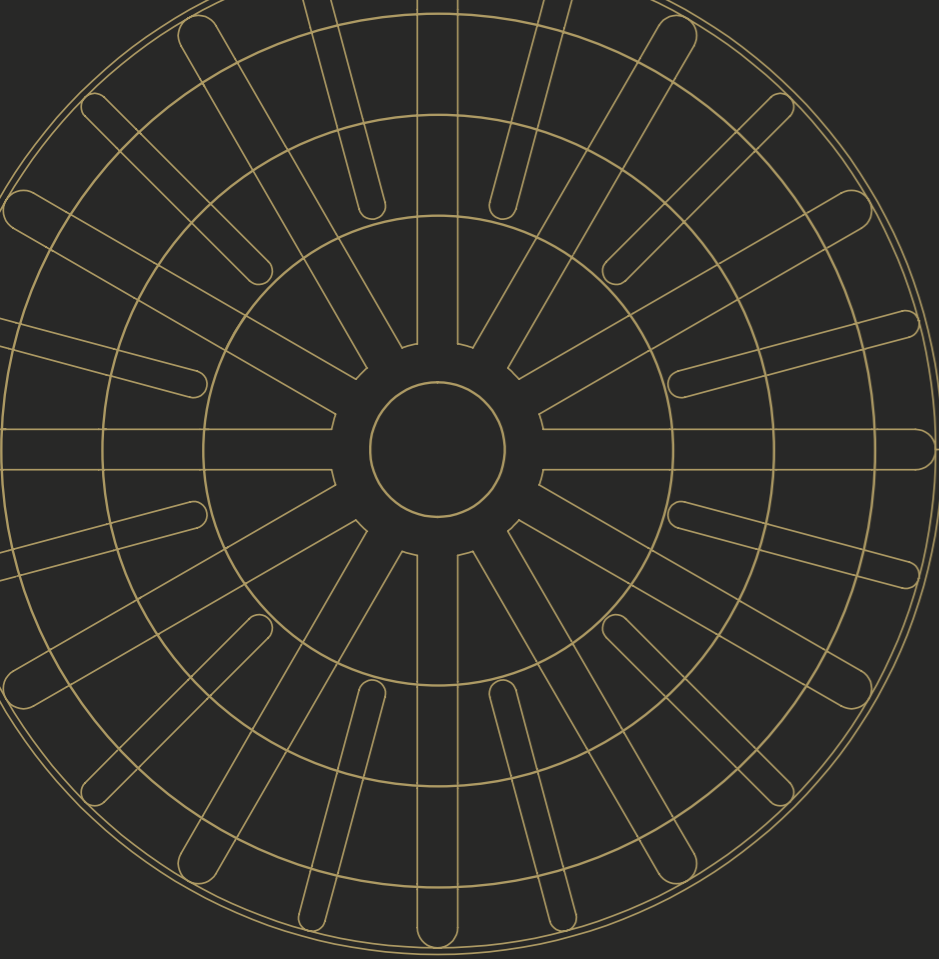
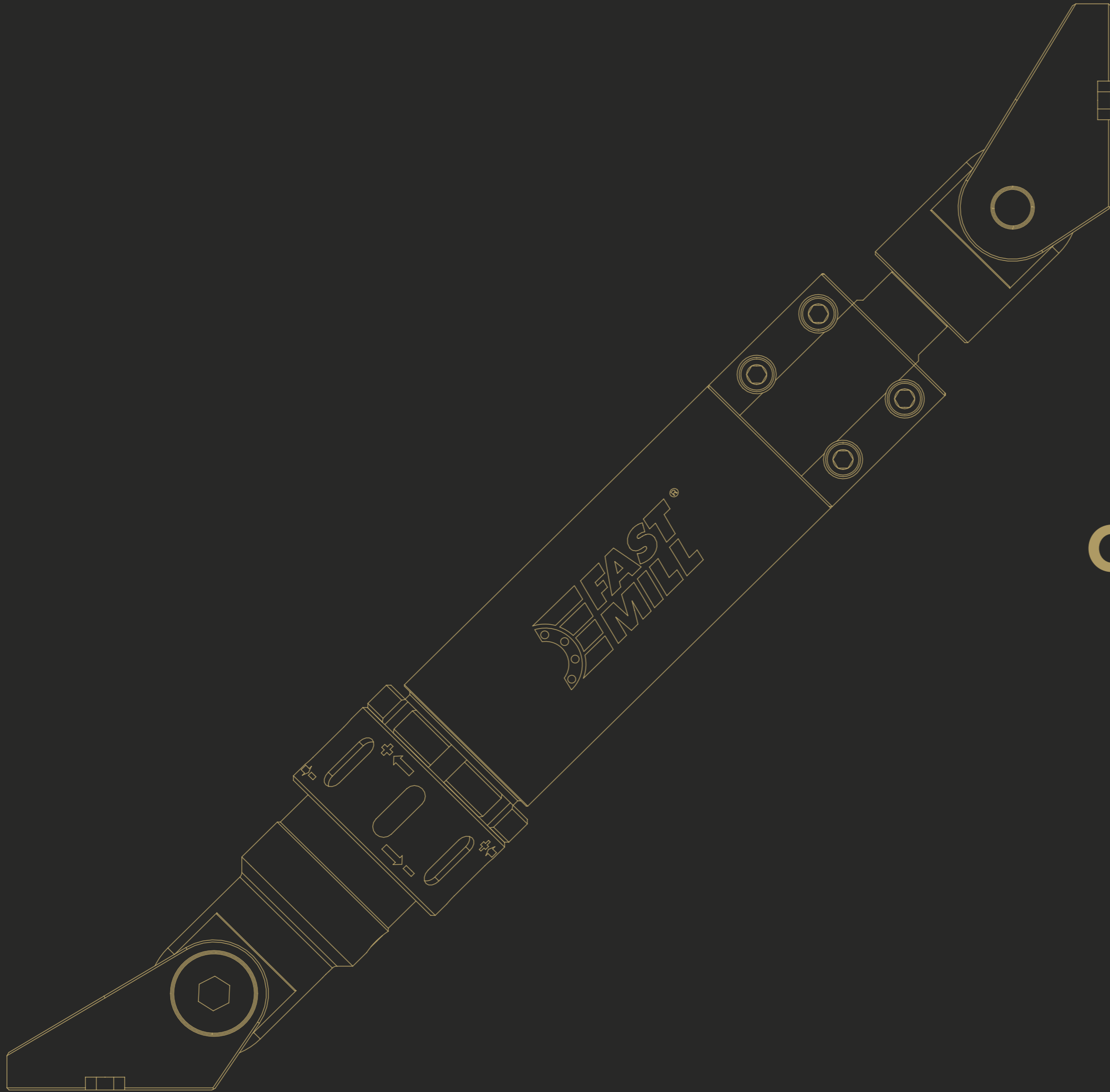

THIRD CLAMPING POINT



THIRD CLAMPING POINT SET

A third clamping point for roughing, finishing and drilling operations of pieces fixed in a vertical position. Thanks to its rigid telescopic system and its additional modular extensions, the third clamping point supports workpieces and opposes vibrations and flexures caused by machining operations, thus avoiding the use of expensive, heavy and bulky fastening brackets. The third clamping point can be fixed directly on plates or workpieces by means of standard TCEI screws or FASTMILL® coordinate modules/risers. Alternatively, it can be fixed on the machine's T-slots. In addition to fixing, thanks to its efficient fine adjustment system, it can be adjusted for the purposes of thrust or traction to ensure verticality of workpieces before their machining.

CODE	DESCRIPTION	DIMENSION
FM46191600	Third clamping point set	630/820 (24,80"/32,28")
SET CONFIGURATION		N°
Third clamping point		1 piece
C-hook spanner 92-95		1 piece
Bush Ø24-24 mm		2 pieces
Cylindrical head hexagon socket screw 12.9 (DIN912)		2 pieces

ACCESSORIES

CODE	DESCRIPTION	DIMENSION
FM46191650	Extension	+ 200 (7,87")
FM93000019	Hook wrench	

⚠ Not included in the set.

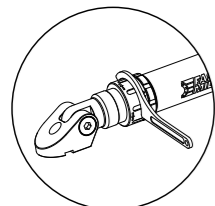

C-HOOK SPANNER 92-95 APPLICATION

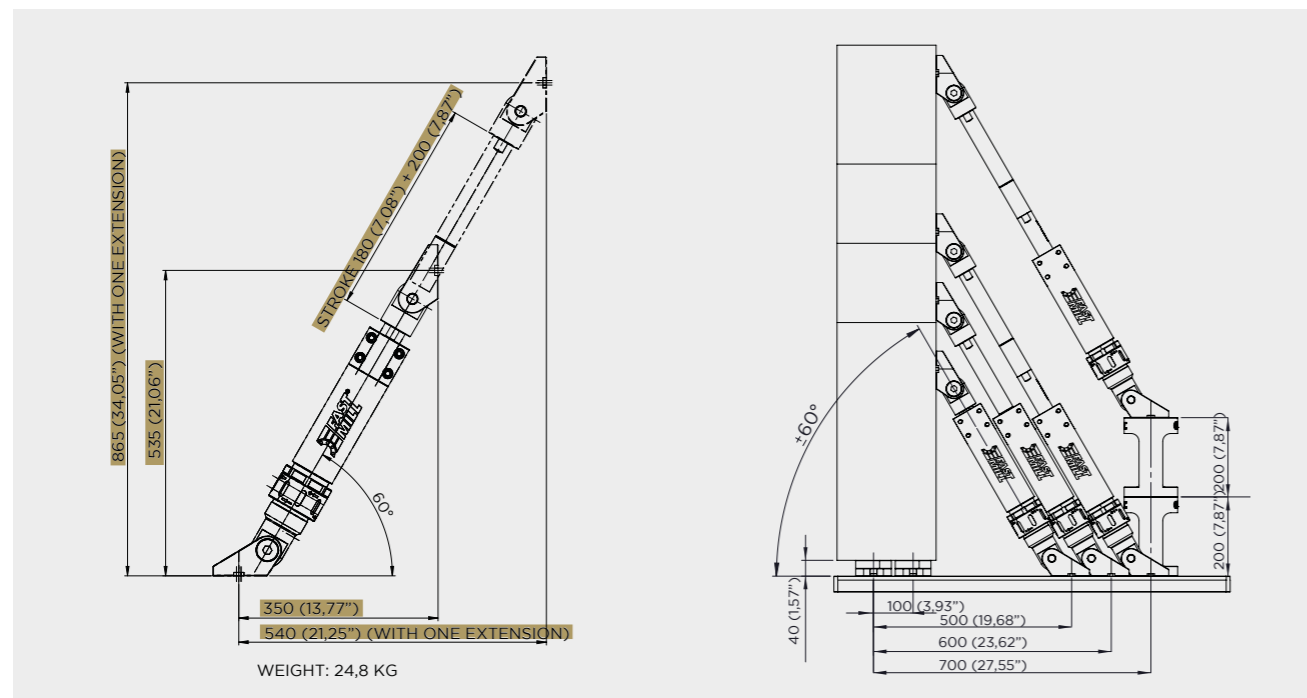
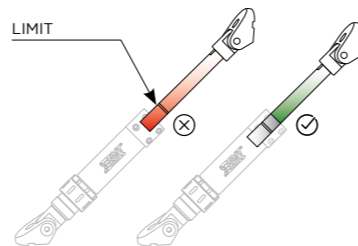
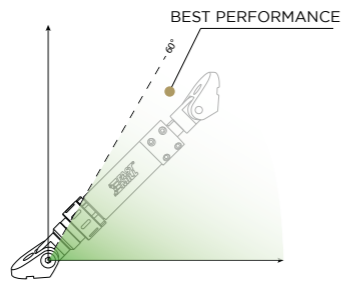

THIRD CLAMPING POINT SET



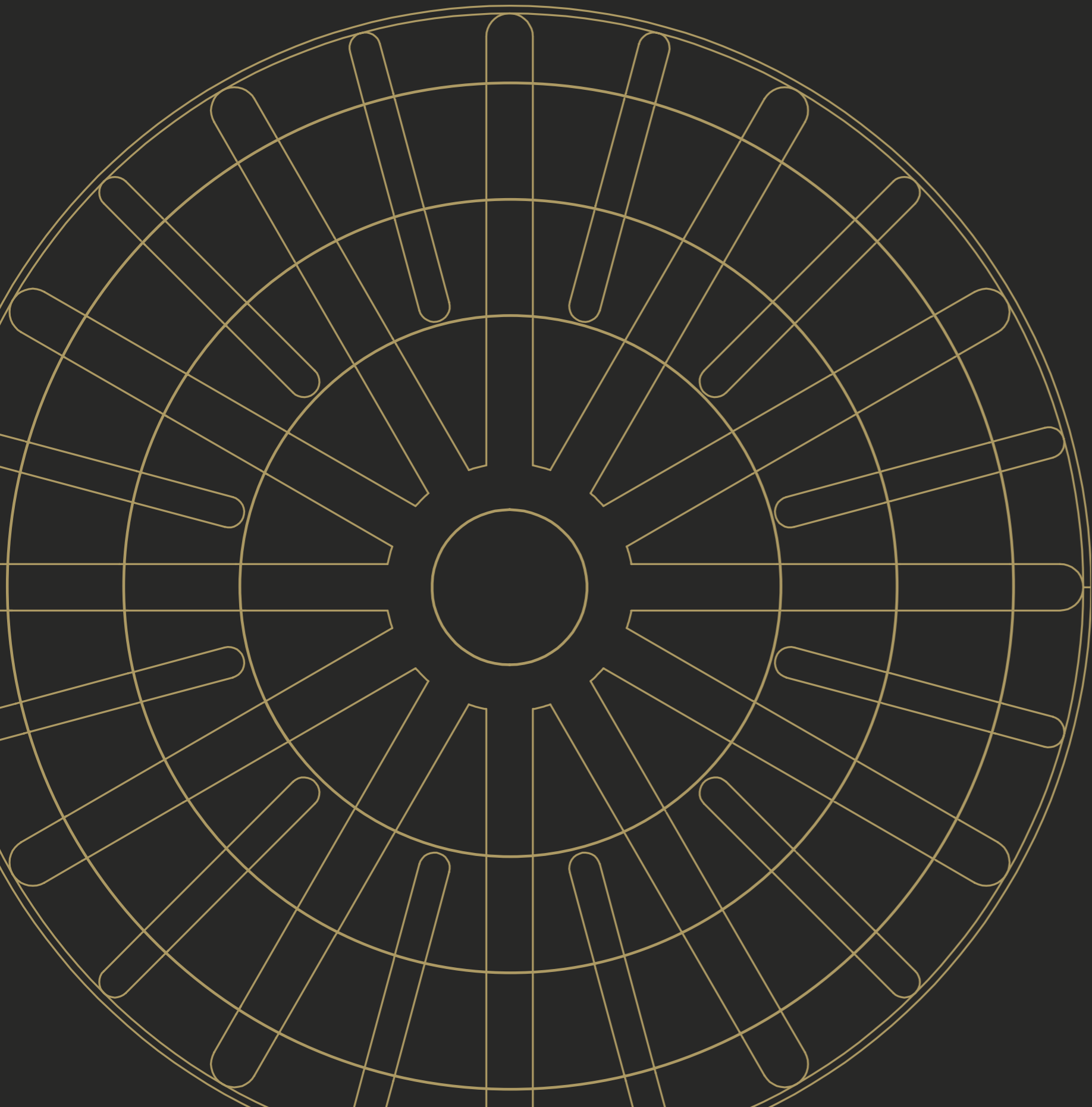

MAGNETIC



MAGNETIC MODULE

Magnetic module is an extremely versatile element made with manually operated permanent magnets. Thanks to the Fastmill interface on the back face, it can be used on top of a module or connected to a third point. Some of the applications are for example:

- create a magnetic chuck for the pre-process phase directly on FastMill modules
- fastening of welded structures
- fastening thin walls, where normally it is not possible to make a threaded hole
- fixing or absorbing working vibrations on strategic points of the structure when connected to a third point.

CODE	DESCRIPTION	Ø
FM46191660	MAGNETIC MODULE	150 (5,90")

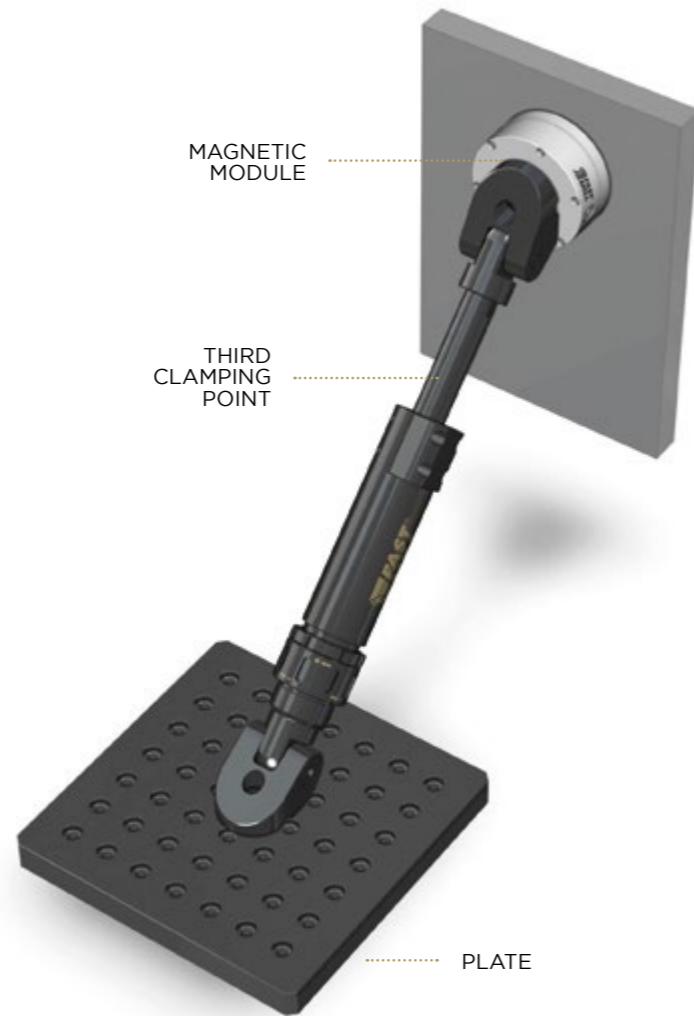
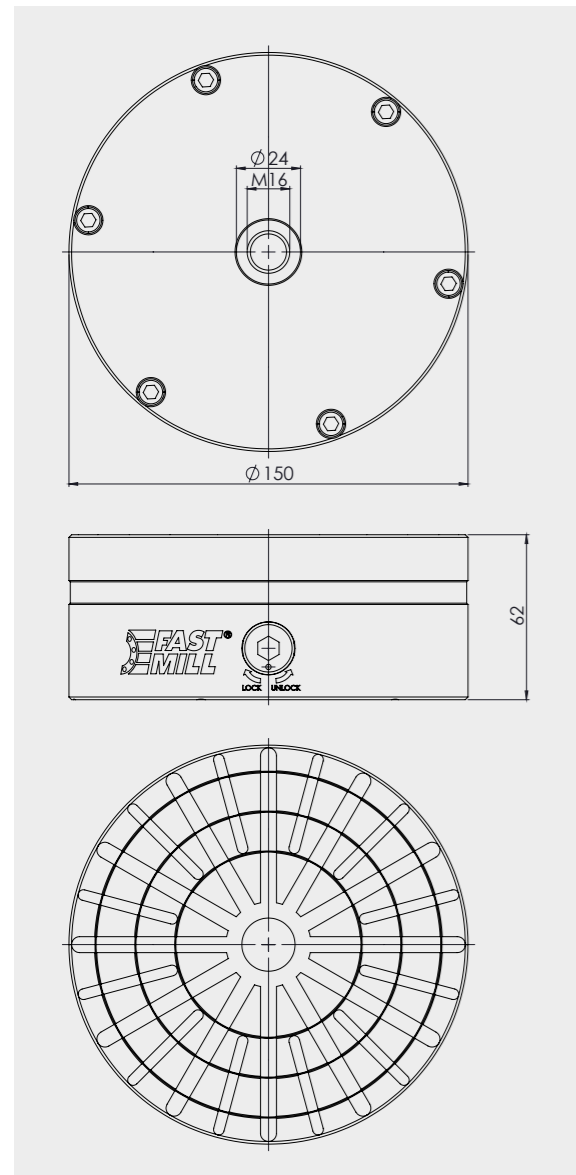

MAGNETIC MODULE - PRE-PROCESS MACHINING EXAMPLE

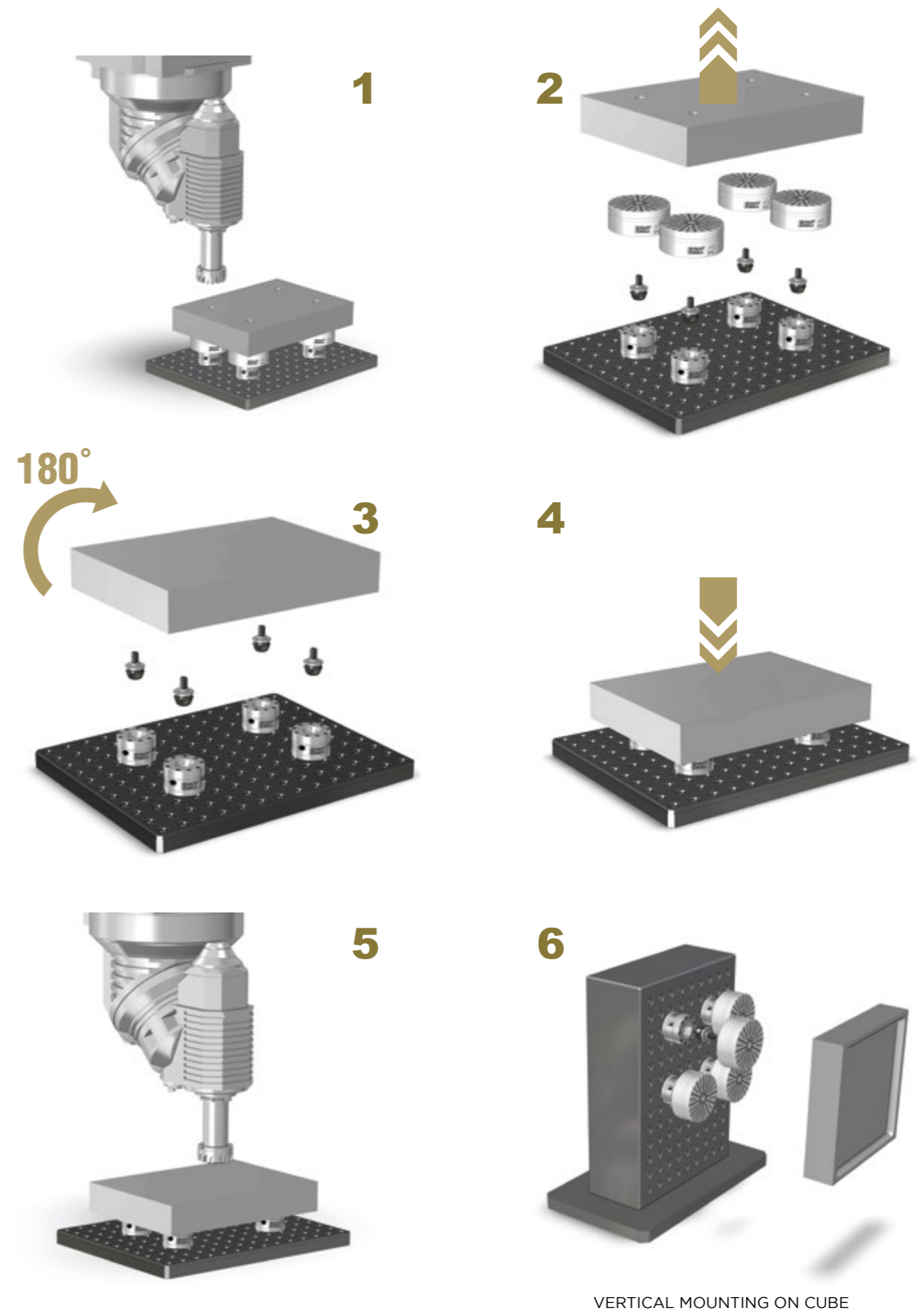

VERTICAL MOUNTING ON CUBE

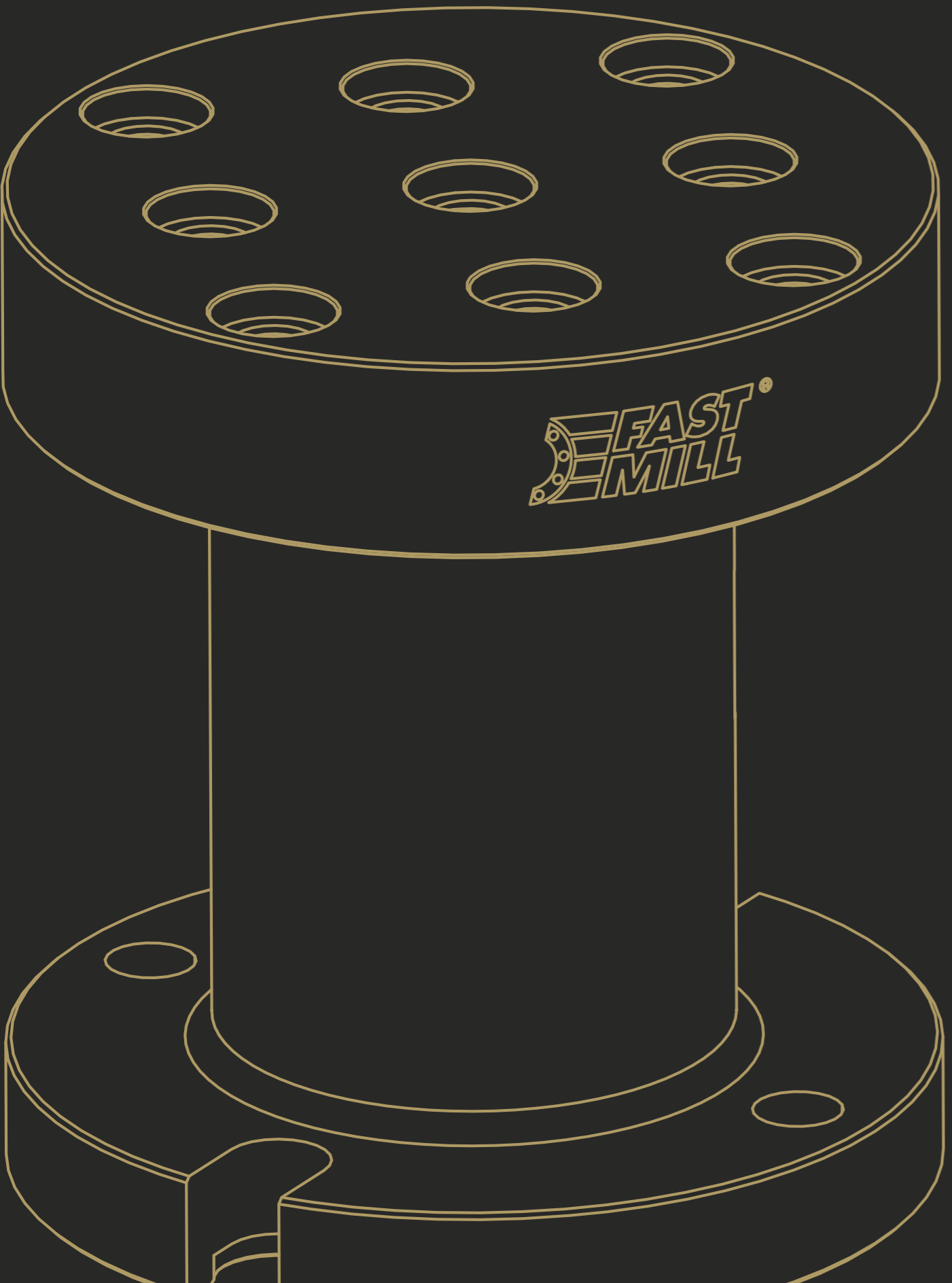

RISERS

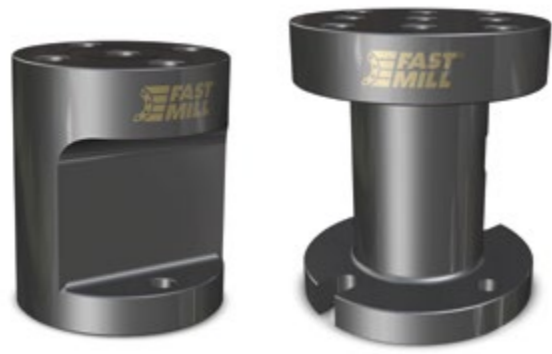

RISER Ø135 - Ø175

The FastMill riser range is used to raise the entire clamping set up in the Z direction while maintaining a solid support surface. Thanks to the precise centering, the position of the counterbore corresponds to that of the FastMill plate on which the riser is mounted. Available in two sizes and diameters to cover all needs.

CODE	DESCRIPTION	Ø	HEIGHT	WEIGHT
FM46192060	Riser	135 (5,31")	160 (6,29")	13 (28,66 lbs)
FM46192050	Riser	175 (6,88")	200 (7,87")	20 (44,09 lbs)



90° INDEX RISER SET

90° Index riser set is an accessory able to quickly mount a module in a vertical position, thus expanding the possibility of machining on 3-axis machines or for any particular needs and also comes with a removable key for use with standard modules and indexed modules.

CODE	DESCRIPTION
FM90IR0016024	90° Index riser set

SET CONFIGURATION	N°
Feather key 12H6X8X30 for index	1 piece
Bush Ø24-24 mm	5 pieces
TCEI M4X10 mm UNI 5931 inox screw	1 piece
TCEI M16X60 mm UNI 5931-12,9 screw	3 pieces

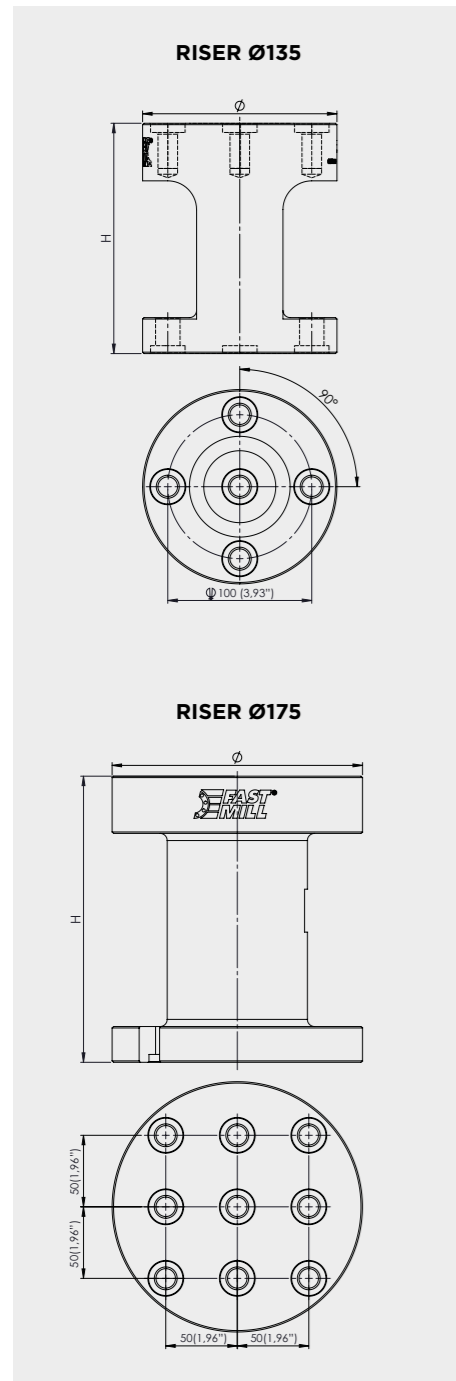

RISER ASSEMBLY EXAMPLE



SETUP EXAMPLE

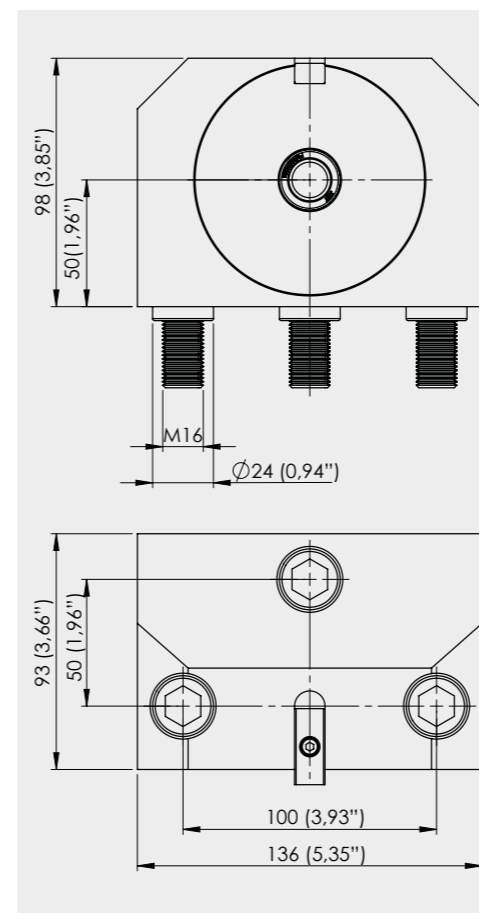
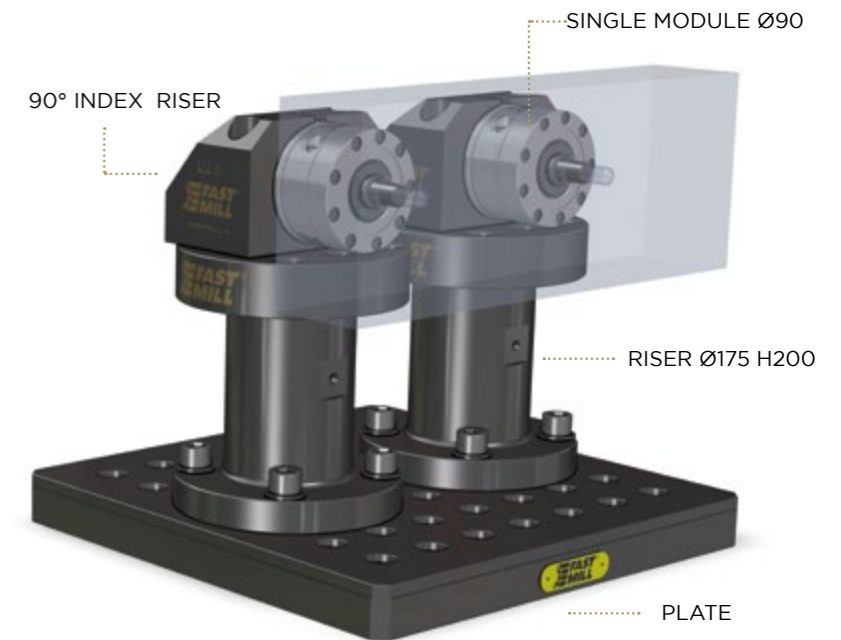

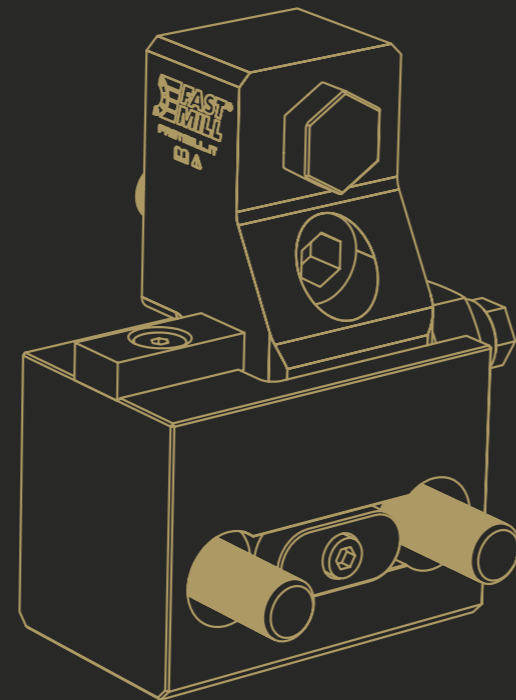
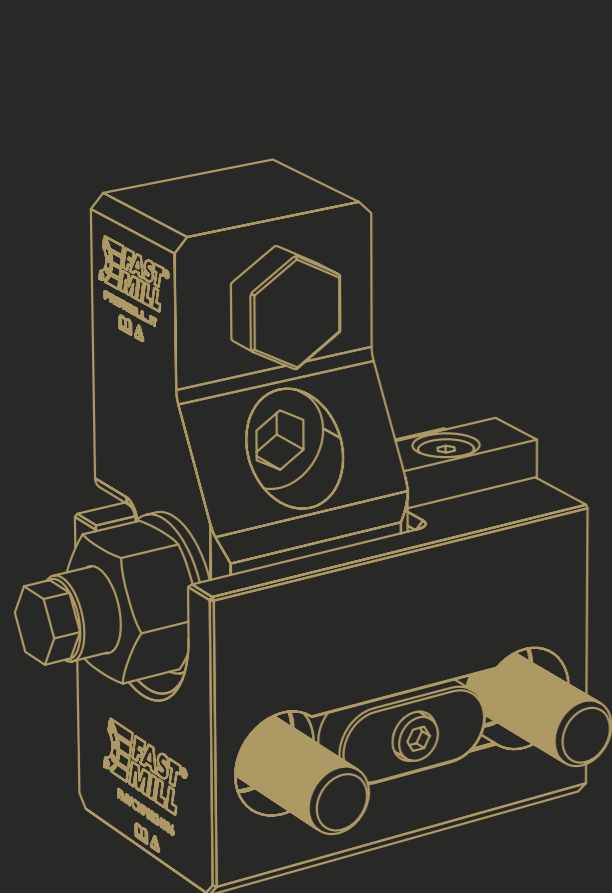
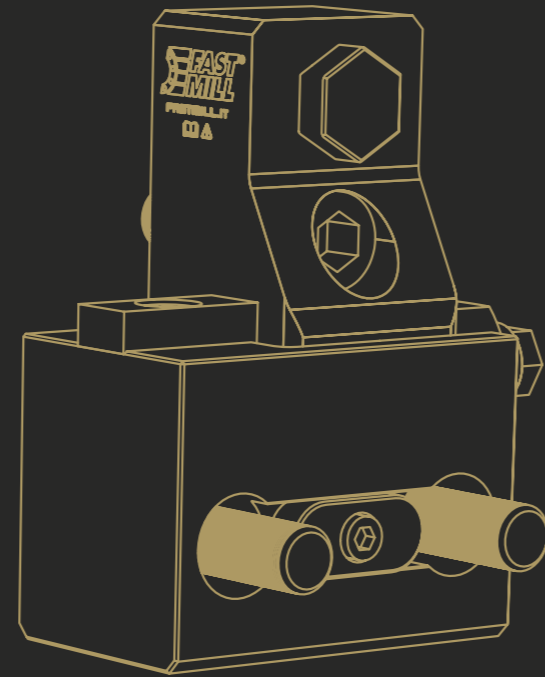
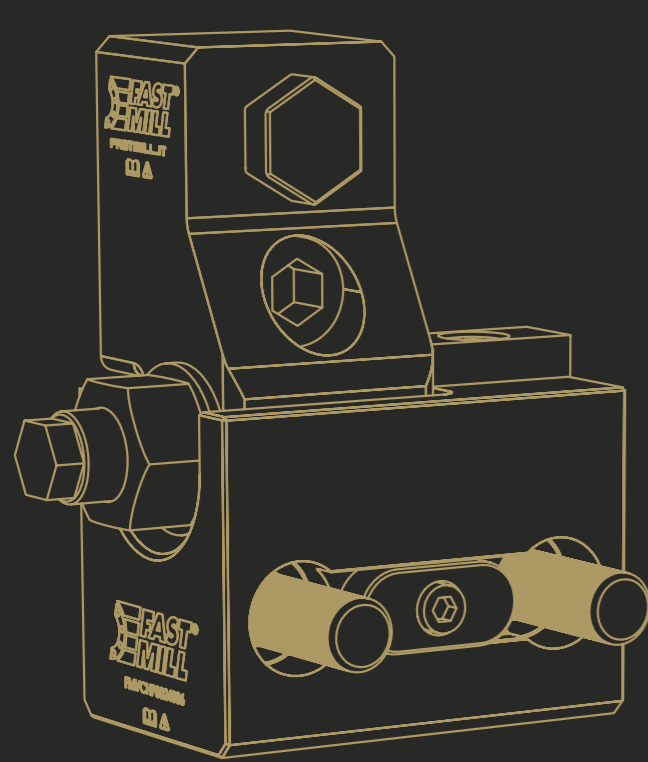

VERTICAL CLAMPING



VERTICAL CLAMPING FOR HEAVY PARTS SET

FastMill vertical clamping system is used for clamping heavy workpieces in vertical positions. It is a robust element allowing ease of use. It also allows the management of a workpiece of considerable size safe handling. A single operator can set up at a safe distance from the initial handling to the start of machining.

CODE	
FMVCHP0024036	Vertical clamping for heavy parts set

SET CONFIGURATION	N°
Special bush Ø36-36 mm h 20 mm	8 pieces
TE M24X60 UNI 5739-8,8	4 pieces
31X56 UNI 6592-69 washer	4 pieces
Feather key 28X16X60 DIN6885 C	4 pieces
M30 NUT UNI 5589 -8G	4 pieces
TCEI M24X80 UNI 5931-12,9 screw	4 pieces
TCEI M10X20 UNI 5931-12,9 screw	4 pieces



90° LATERAL CLAMPING ACCESSORIES

CODE	DESCRIPTION	DIMENSION	HEIGHT	WEIGHT
FMVCHPLATERAL	90° Lateral clamping accessories	98x60 (3,85"x2,36")	110 (4,33")	2,7 (5,95 lbs)

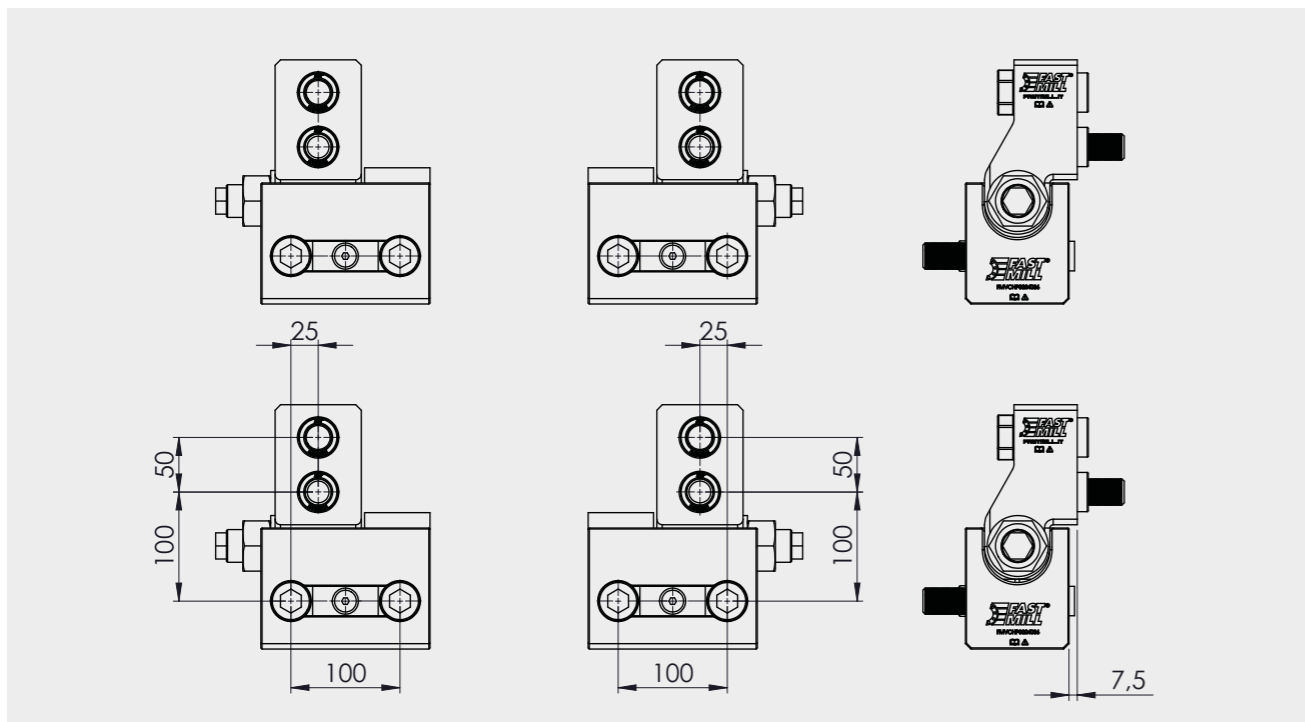

SETUP EXAMPLE

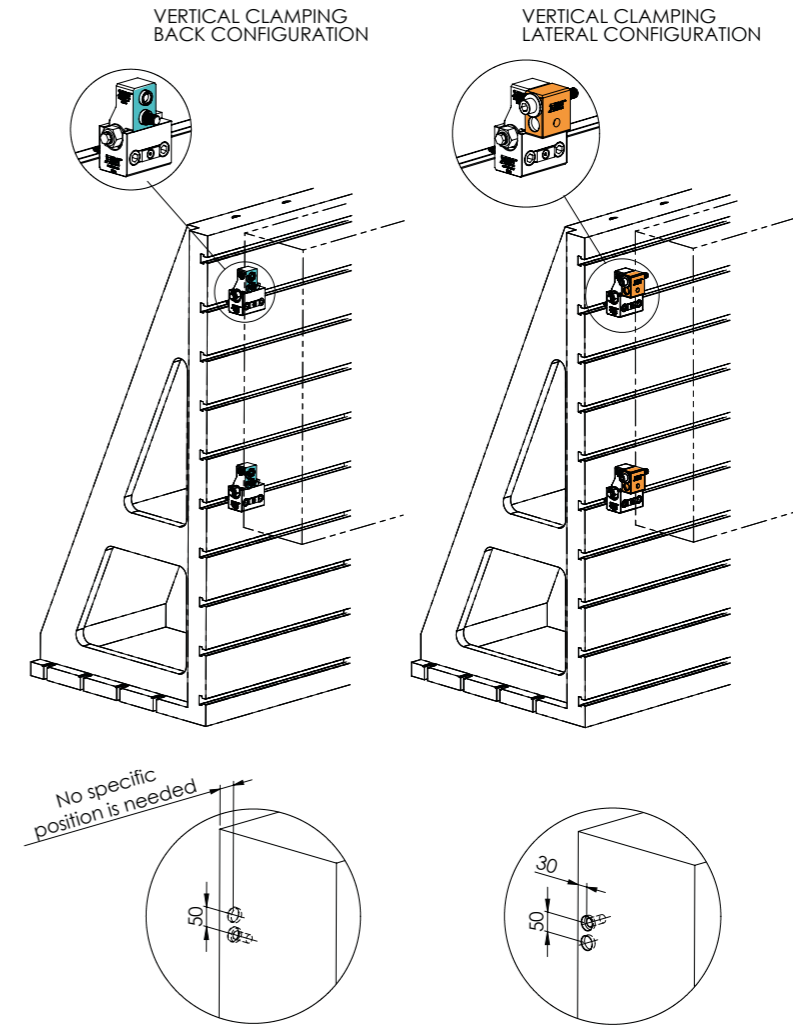

SETUP EXAMPLE

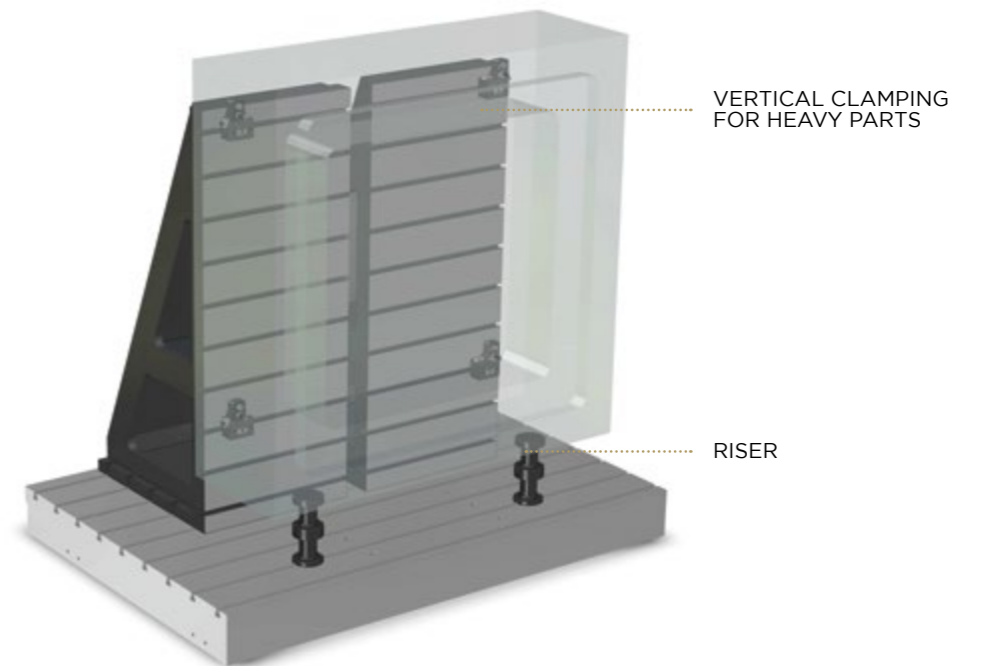



VERTICAL CLAMPING AND POSITIONING SET

Vertical clamping and positioning system allows a vertical type of fixing on medium-sized components, while ensuring a known position of the piece with respect to space. The system works using our standard Fastmill modules to which appropriate accessories are applied for vertical assembly. a lateral fixing accessory is also available in cases with no possibility of fixing on the back of the workpiece.

CODE	
FMVCAPO016024	Vertical clamping and positioning set

SET CONFIGURATION	N°
Bush Ø24-24 mm	6 pieces
TCEI M16X60 mm UNI 5931-12,9 screw	3 pieces
TCEI M16X40 mm UNI 5931-12,9 screw	1 pieces
TCEI M16X20 mm UNI 5931-12,9 screw	1 pieces
TE M16X100 mm UNI 5739-12,9 screw	1 pieces
Feather key 28X16X60 DIN6885 C	1 pieces
17x30 UNI 6592-69 washer	1 pieces

SETUP EXAMPLE

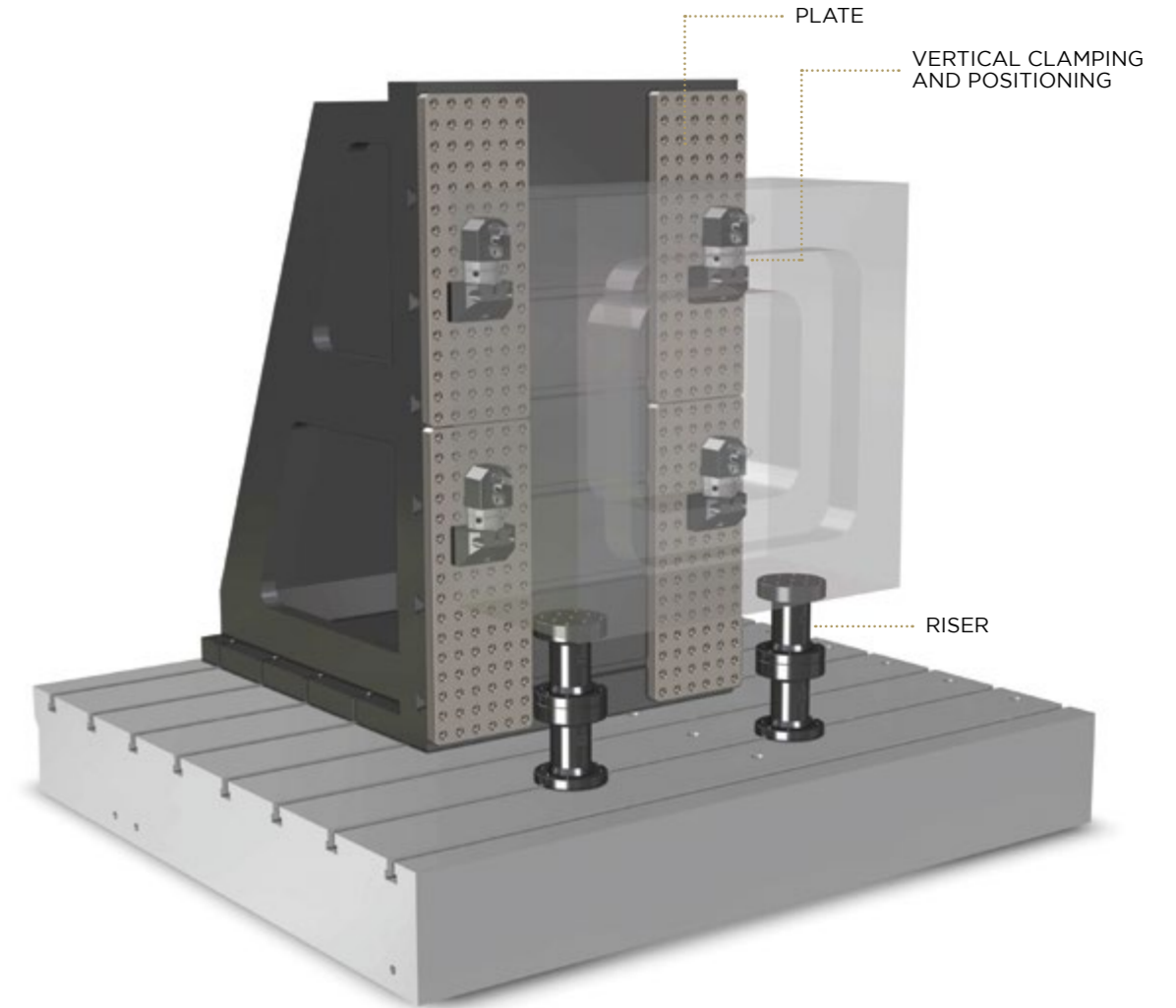

90° LATERAL CLAMPING ACCESSORIES

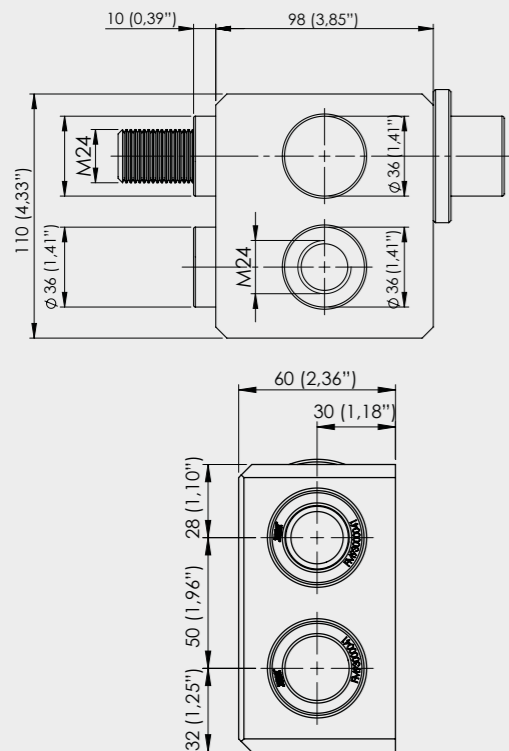

VERTICAL CLAMPING AND POSITIONING SET

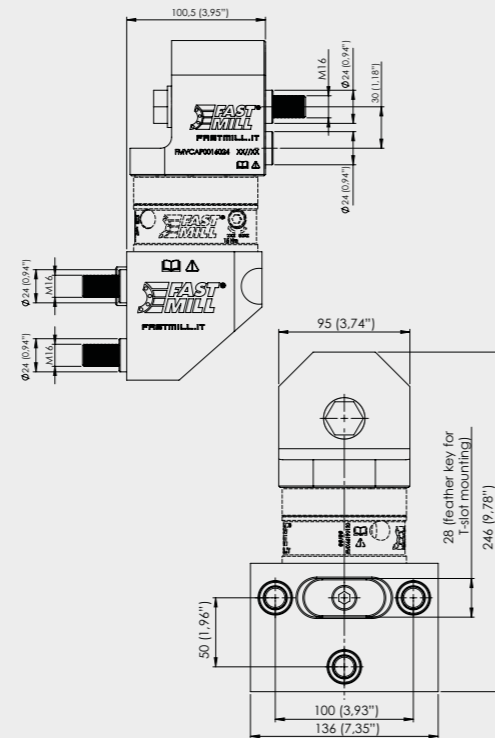

⚠ Module and pin not included.

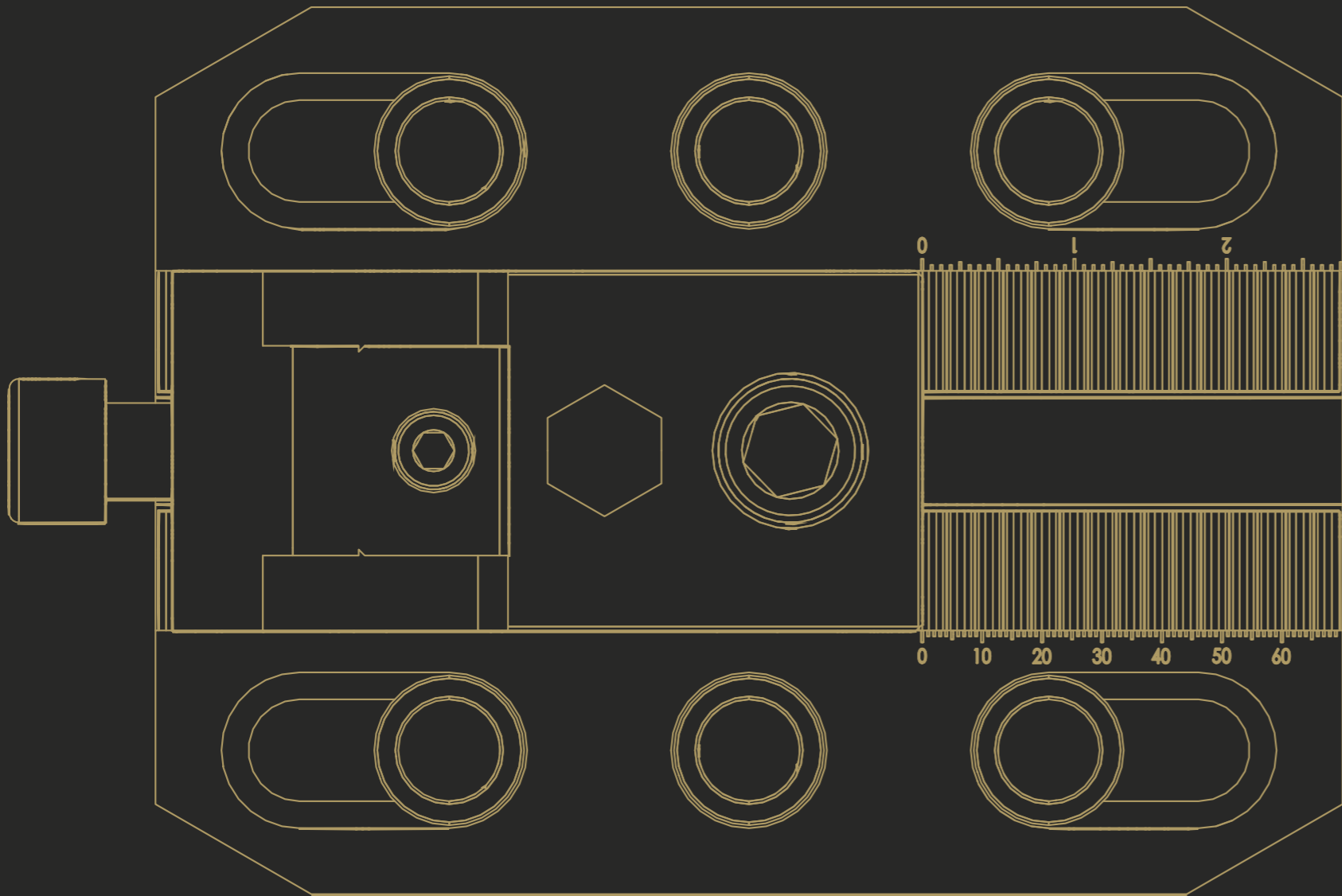

CLAMPS



MODULAR CLAMP

Useful for pre-process operations, the FastMill Modular Clamp allows you to fix pieces of various sizes with maximum rigidity and practicality. Simple to install and to handle with just a few operations, the FastMill modular clamp allows the operator to start machining on the workpiece.

CODE	DESCRIPTION	DIMENSION	HEIGHT	WEIGHT
FM51991700	Modular clamp	198x148 (7,79"x5,82")	136 (5,35")	11,8 (26 lbs)



FIXED CLAMP

FastMill Fixed Clamp are used in tandem with our Modular Clamp to support workpiece clamping. Versatile and functional, they can also act as reference points when the operator needs to position several workpieces at the same X-Y coordinates.

CODE	DESCRIPTION	DIMENSION	HEIGHT	WEIGHT
FM51991800	Fixed clamp	60x125 (2,36"x4,92")	131 (5,15")	5,8 (12,7 lbs)

CLAMPS ASSEMBLY EXAMPLE

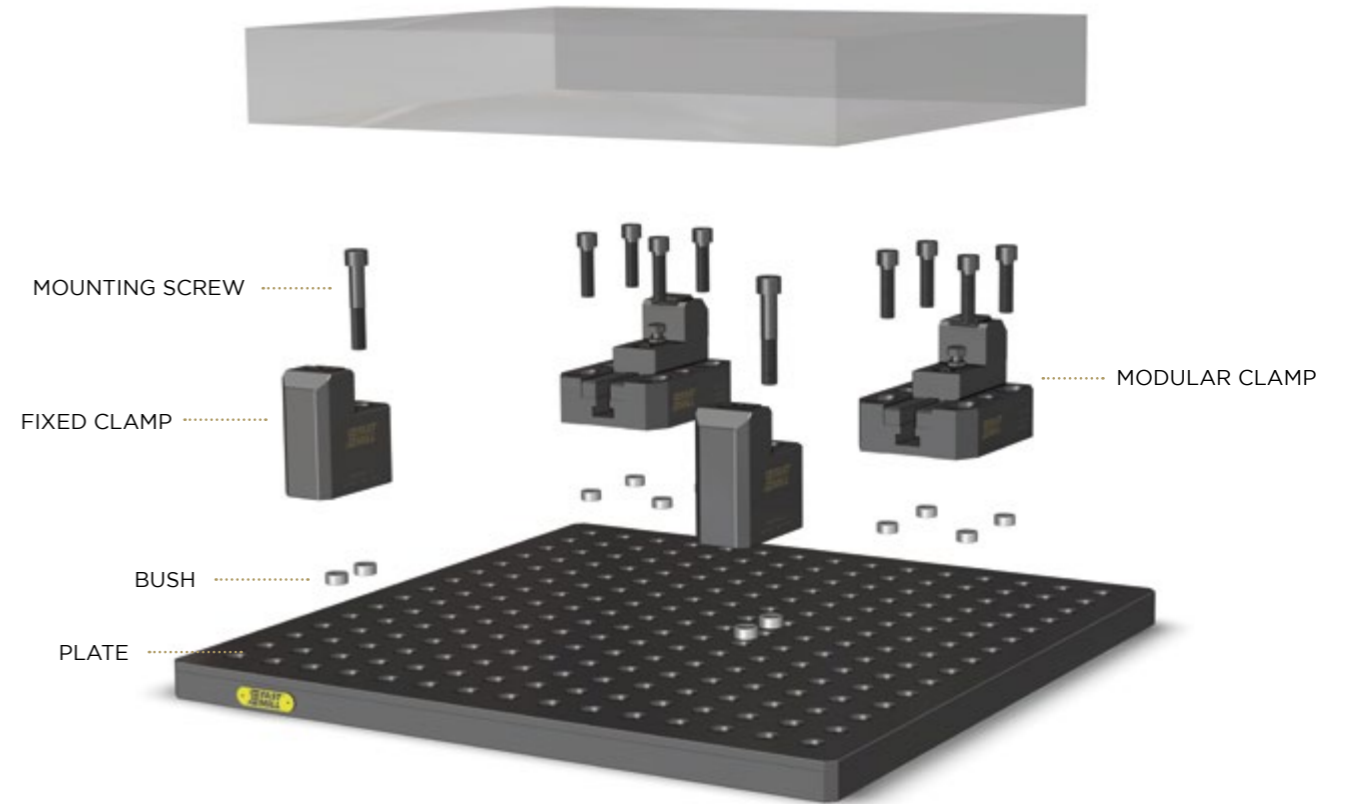

CLAMPS ASSEMBLY EXAMPLE

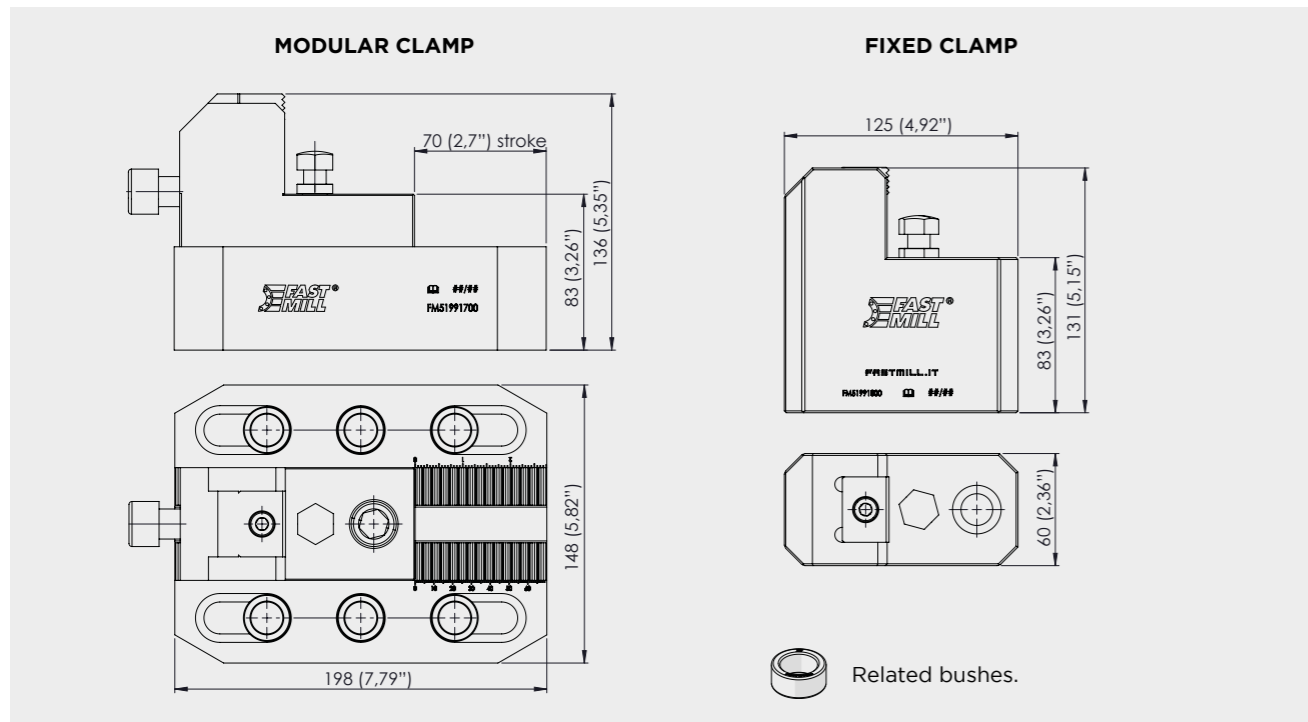
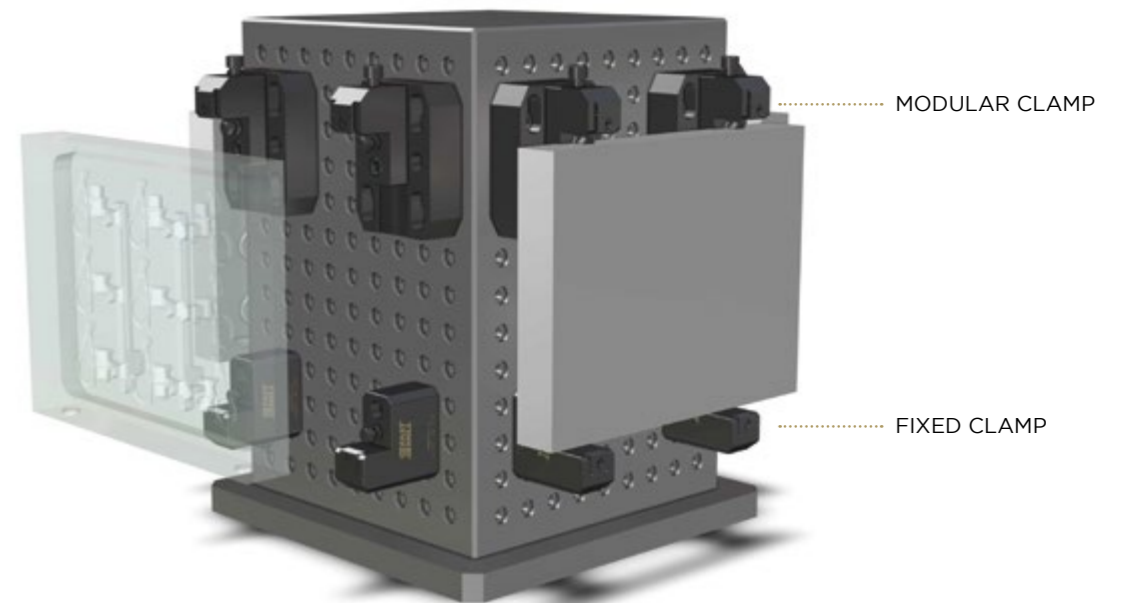



TERÄSK^{100v}NTTORI
K-D GROUP

www.teraskonttori.fi

Myynti:  tilaus@teraskonttori.fi

 030 600 3611

 www.neTKonttori.fi