

# MANUAL CLAMPING ACCESSORIES

## Manual Clamping Accessory Overview



Flat-Tip Bonded  
Neoprene Spindle – Inch



Large Diameter Padded  
Swivel Foot Spindle – Inch



Neoprene Caps



Special Neoprene  
Caps



Metric Flat-Tip Bonded  
Neoprene Spindle – Metric



Swivel Foot  
Spindle



Polyurethane Caps



Cone-Tip  
Polyurethane Caps



Round Bonded  
Neoprene Spindle – Metric



Hex Head  
Spindle



Bolt Retainers



Flanged Washers



Cone-Tip Bonded  
Neoprene Spindle – Metric



Plunger-matic  
Assemblies



Adapters and  
Extensions

### Flat-Tip Bonded Neoprene Spindle – Inch

- Black neoprene, hardness: 70-80 Shore A
- Temperature Range: -20°C to 100°C [-22°F to 212°F]
- Oil resistant, LABS (silicone) free
- Includes jam nuts
- Stainless steel versions available upon request

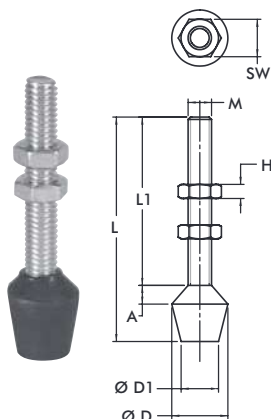

Part No.	M	L	L1	SW	H	A	ØD	ØD1
102208	#8-32	[1.25] 31,8	[0.94] 23,8	[0.34] 8,7	[0.13] 3,2	[0.06] 1,6	[0.56] 14,3	[0.44] 11,1
105208		[1.00] 25,4	[0.69] 17,4					
201208	#10-32	[1.38] 35,1	[1.01] 25,5	[0.38] 9,5	[0.13] 3,2	[0.13] 3,2	[0.63] 16	[0.47] 12
202208		[1.63] 41,4	[1.08] 27,4					
215208	1/4-20	2.13 54,1	[1.58] 40,1	[0.44] 11,1	[0.16] 4	[0.12] 3	[0.66] 16,8	[0.50] 12,7
424208		[1.50] 38,1	[1.12] 28,5					
431208		[1.00] 25,4	[0.62] 15,8					
225208	5/16-18	[2.25] 57,2	[1.54] 39,1	[0.50] 12,7	[0.19] 4,8	[0.20] 5	[0.83] 21	[0.55] 14
507208		[3.00] 76,2	[2.29] 58,2					
240208	3/8-16	[3.25] 82,6	[2.31] 58,5	[0.56] 14,3	[0.22] 5,6	[0.20] 5	[1.02] 26	[0.79] 20
527208		[3.50] 88,9	[2.50] 63,5					
235208		[5.75] 146,1	[4.77] 121,1					
247208	1/2-13	[3.87] 98,3	[2.73] 69,3	[0.75] 19,1	[0.31] 7,9	[0.28] 7	[1.18] 30	[0.95] 24
267208	5/8-11	[5.00] 127	[3.63] 92,1	[0.94] 23,8	[0.38] 9,5	[0.38] 9,5	[1.38] 35,1	[1.00] 25,4

### Flat-Tip Bonded Neoprene Spindle – Metric

- Red neoprene, hardness: 80-85 Shore A
- Temperature Range: -20°C to 100°C [-22°F to 212°F]
- Oil resistant, LABS (silicone) free
- Includes jam nuts

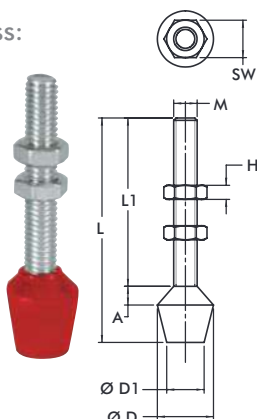

Part No.	M	L	L1	SW	H	A	ØD	ØD1
431208-M	M6	[1.00] 25,4	[0.6] 15,8	[0.39] 10	[0.13] 3,2	[0.13] 3,3	[0.66] 16,8	[0.66] 16,8
424208-M		[1.63] 41,3	[1.25] 31,7					
202208-M		[1.73] 44	[1.18] 30					
215208-M		[2.13] 54	[1.57] 40					
225208-M	M8	[2.09] 53	[1.38] 35	[0.51] 13	[0.16] 4	[0.20] 5	[0.83] 21	[0.55] 14
2007208-M		[2.48] 63	[1.77] 45					
507208-M		[3.27] 83	[2.56] 65					
240208-M	M10	[3.11] 79	[2.17] 55	[0.67] 17	[0.20] 5	[0.20] 5	[1.02] 26	[0.78] 20
235208-M		[4.72] 120	[3.74] 95					
247208-M	M12	[4.02] 102	[2.87] 73	[0.75] 19	[0.24] 6	[0.28] 7	[1.18] 30	[0.94] 24

Part No.	M	L	L1	SW	H	A	ØD
205208-M	M4	[0.87] 22	[0.79] 20	[0.28] 7	[0.09] 2,2	[0.11] 2,8	[0.32] 8
201208-M		[1.26] 32	[1.18] 30				
305208-M	M5	[1.14] 29	[0.98] 25	[0.32] 8	[0.11] 2,7	[0.20] 5	[0.39] 10
213208-M		[1.34] 34	[1.18] 30				
2013208-M		[1.54] 39	[1.38] 35				
307208-M	M8	[1.69] 43	[1.38] 35	[0.51] 13	[0.16] 4	[0.35] 9	[0.75] 19
309208	3/8-16	[2.74] 69,6	[2.19] 55,6	[0.56] 14,3	[0.22] 5,6	[0.55] 14	[0.86] 21,8

Part No.	D	L	L1	ØG
213208-M-L <sup>①</sup>	[0.24] 6	[1.34] 34	[1.18] 30	M5

<sup>①</sup> Item is available upon request.

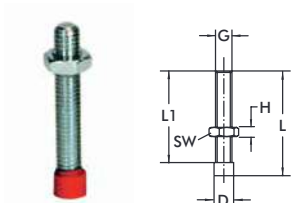

# SPINDLES

## Manual Clamping Accessories | Technical Information | Dimensions

### Cone-Tip Bonded Neoprene Spindle – Inch

- Black neoprene, hardness: 70-80 Shore A
- Temperature Range: -20°C to 100°C [-22°F to 212°F]
- Oil resistant, LABS (silicone) free
- Includes jam nuts

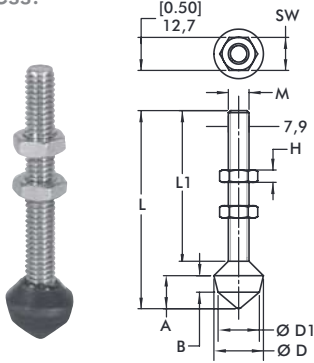

Part No.	M	L	L1	SW	H	A	B	ØD	ØD1
305208	#10-32	[1.50] 38,1	[1.00] 25,4	[0.38] 9,5	[0.13] 3,3	[0.38] 9,5	[0.19] 4,8	[0.56] 14,2	[0.44] 11,2
213208	1/4-20	[2.25] 57,2	[1.56] 39,6	[0.44] 11,2	[0.16] 4,0	[0.50] 12,7	[0.25] 6,4	[0.75] 19,1	[0.63] 16
509208	5/16-18	[3.00] 76,2	[2.28] 57,9	[0.50] 12,7	[0.19] 4,8				
519208		[5.50] 139,7	[4.75] 120,7						
210208	3/8-16	[3.50] 88,9	[2.50] 63,5	[0.56] 14,2	[0.23] 5,8	[0.75] 19,1	[0.41] 10,4	[0.88] 22,4	[0.75] 19,1

### Large Diameter Padded Swivel Foot Spindle-Inch

- White neoprene, hardness: 70-80 Shore A
- Temperature Range: -40°C to 105°C [-40°F to 220°F]
- Non-marking neoprene
- Includes jam nuts

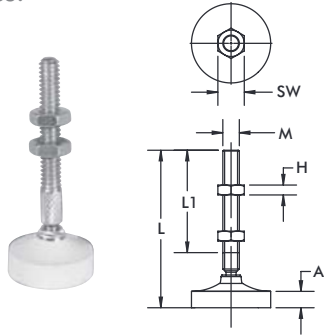

Part No.	M	L	L1	SW	H	A	ØD	Swivel Angle
207209	1/4-20	[2.56] 65	[1.56] 39,6	[0.44] 11,2	[0.16] 4	[0.31] 8	[1.00] 25,4	14°
507209	5/16-18	[2.98] 75,7	[1.94] 49,3	[0.50] 12,7	[0.19] 4,8		[1.50] 38,1	24°
210209	3/8-16	[3.56] 90,4	[2.44] 62	[0.56] 14,2	[0.23] 5,8		[2.00] 50,8	26°

### Plunger-matic Assemblies

- For use with Straight Line Action clamps
- Internal compression spring compensates for variations in material thickness
- Zinc plated
- Includes jam nut

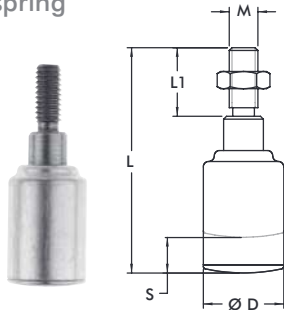

Part No.	M	L	L1	ØD	Max. Compression S	Spring Constant [lbf./in] N/mm	Max. Force [lbf.] N
905	5/16-18	[2.50] 63,5	[0.75] 19,1	[0.88] 22,2	[0.19] 4,8	[750] 131	[190] 845
905-M	M8						
920	3/8-16	[3.63] 92,2	[1.13] 28,6	[0.88] 22,2	[0.38] [9,6]	[822] 144	[308] 1370
920-M	M10						

### Swivel Foot Spindle

- Includes jam nuts

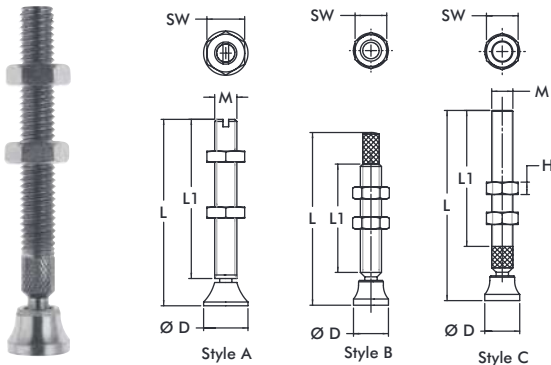

Part No.	M	Style	L	L1	SW	H	ØD	Swivel Angle
207206-M	M6	A	[2.44] 62	[2.13] 54	[0.39] 10	[0.13] 3,2	[0.47] 12	30°
507206-M	M8		[2.87] 73	[2.46] 62,5	[0.51] 13	[0.16] 4	[0.63] 16	
468206-M	M10	B	[3.06] 77,8	[2.00] 50,8	[0.67] 17	[0.20] 5	[0.79] 20	24°
210206-M		A	[3.31] 84	[2.80] 71			[0.79] 20	
250206-M	M12	A	[4.72] 120	[4.13] 105	[0.75] 19	[0.24] 6	[0.98] 25	30°
207206	1/4-20	C	[2.38] 60,5	[1.56] 39,6	[0.44] 11,2	[0.16] 4	[0.50] 12,7	
507206	5/16-18		[2.75] 69,9	[1.94] 49,3	[0.50] 12,7	[0.19] 4,8	[0.56] 14,2	
468206	3/8-16	B	[3.06] 77,7	[1.92] 48,8	[0.56] 14,2	[0.23] 5,8	[0.63] 16	24°
210206		C	[3.38] 85,9	[2.41] 61,2			[0.63] 16	
250206	1/2-13	C	[4.63] 117,6	[3.44] 87,4	[0.75] 19,1	[0.31] 7,9	[1.00] 25,4	24°

### Hex Head Spindle – Stainless Steel

- Includes Plain hexagonal head
- Includes Fully threaded
- Includes Stainless steel, type 303
- Includes jam nuts

Part No.	M	L	L1	SW	H	Part No.	M	L	L1	SW	H
205943-M	M4	[0.89] 22	[0.79] 20	[0.28] 7	[0.09] 2,2	205943	#8-32	[0.86] 21,8	[0.75] 19,1	[0.25] 6,4	[0.13] 3,2
201943-M	M5	[1,32] 33,5	[1.18] 30	[0.31] 8	[0.11] 2,7	201943	#10-32	[1,37] 34,8	[1,37] 34,8	[0.31] 8	
202916-M	M6	[1.75] 44,4	[1.57] 40	[0.51] 12,8	[0.13] 3,2	202943	1/4-20	[1.67] 42,4	[1.50] 38,1	[0.44] 11,1	[0.16] 4
202943-M	M6	[1.73] 42,4	[1.57] 40	[0.39] 10	[0.13] 3,2	207943	5/16-18	[2.72] 69	[2.50] 63,5	[0.50] 12,7	[0.19] 4,8
207943-M	M8	[2.77] 70,3	[2.56] 65	[0.51] 13	[0.16] 4	237943	3/8-16	[2.75] 69,9		[0.56] 14,2	[0.22] 5,6
237943-M	M10	[2.76] 70	[2.56] 65	[0.51] 13	[0.16] 4	442943	5/16-18	[1.97] 50,1	[1.75] 44,5	[0.50] 12,7	[0.19] 4,8
325943-M	M12	[2.87] 73	[2.56] 65	[0.75] 19	[0.24] 6						

### Hex Head Spindle

- Plain hexagonal head
- Fully threaded
- Zinc plated
- Includes jam nuts

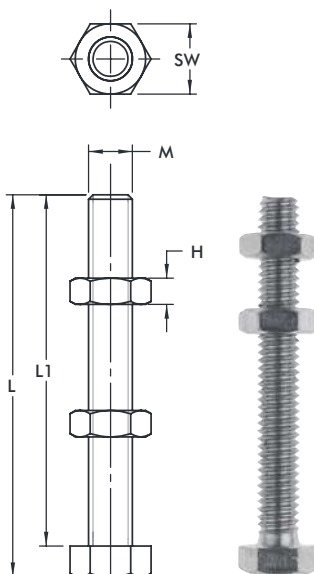

Part No.	M	L	L1	SW	H	Part No.	M	L	L1	SW	H
305908-M	M5	[1.32] 33,5	[1.18] 30	[0.31] 8	[0.11] 2,7	105203*	#8-32	[0.86] 21,8	[0.75] 19,1	[0.25] 6,4	[0.13] 3,3
205203-M	M6	[1.93] 49	[1.77] 45	[0.39] 10	[0.13] 3,2	305203	#10-32	[1.12] 28,4	[1.00] 25,4	[0.31] 8	
461203-M	M8	[1.20] 30,5	[0.98] 25	[0.51] 13	[0.16] 4	205203	1/4-20	[1.92] 48,8	[1.75] 44,5	[0.44] 11,2	[0.16] 4
441203-M		[1.99] 50,5	[1.77] 45			[3.17] 80,5		[3.00] 76,2			
207203-M		[2.97] 75,5	[2.76] 70			461203		[1.22] 31	[1.00] 25,4		
491203-M	M10	[1.85] 47	[1.57] 40	[0.67] 17	[0.20] 5	441203	5/16-18	[1.97] 50	[1.75] 44,5	[0.50] 12,7	[0.19] 4,8
210203-M		[3.03] 77	[2.76] 70			[2.72] 69,1	[2.50] 63,5				
240203-M	M12	[4.21] 107	[3.94] 100	[0.75] 19	[0.24] 6	491203	3/8-16	[1.75] 44,5	[1.50] 38,1	[0.56] 14,2	[0.23] 5,8
220203-M		[3.46] 88	[3.15] 80			[3.00] 76,2		[2.75] 69,9			
325203-M		[2.85] 72,5	[2.56] 65			240203		[4.25] 108	[4.00] 101,6		
250203-M	M16	[4.33] 110	[3.94] 100	[0.94] 24	[0.28] 7	527203		[5.25] 133,4	[5.00] 127		
267203-M		[5.12] 130	[4.72] 120					325203		[2.84] 72,1	[2.50] 63,5
						220203	1/2-13	[3.34] 84,8	[3.00] 76,2	[0.75] 19,1	[0.31] 7,9
						229203		[3.84] 97,5	[3.50] 88,9		
						250203	5/8-11	[4.42] 111,6	[4.00] 101,6	[0.38] 9,5	[0.38] 9,5

\*Material: nylon

# SPINDLE CAPS

## Manual Clamping Accessories | Technical Information | Dimensions

### Neoprene Caps

- Slip on head of hex-head spindles
- Hardness: 60-70 Shore A
- Temperature range:  
-40°C to 105°C [-40°F to 220°F]

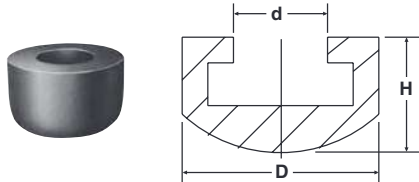

Part No.	D	d	H	For Spindle Diameter
215119	[0.63] 16	[0.25] 6,35	[0.44] 11,1	M6 or 1/4
225119	[0.75] 19,1	[0.31] 8	[0.50] 12,7	M8 or 5/16
235119	[0.88] 22,3	[0.38] 9,7	[0.53] 13,5	3/8

### Special Neoprene Caps

- Slip on threaded spindle rod
- Hardness: 60-70 Shore A
- Temperature range:  
-40°C to 10°C [-40°F to 220°F]

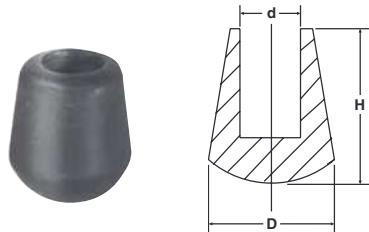

Part No.	D	d	H	For Spindle Diameter
424107	[0.44] 11,1	[0.22] 5,6	[0.44] 11,1	M6 or 1/4
235110	[0.72] 18,3	[0.34] 8,6	[0.88] 22,3	M10 or 3/8

### Polyurethane Caps

- Flat tip, internally threaded
- Hardness: 80 Shore A
- Temperature range:  
-70°C to 95°C [-90°F to 200°F]

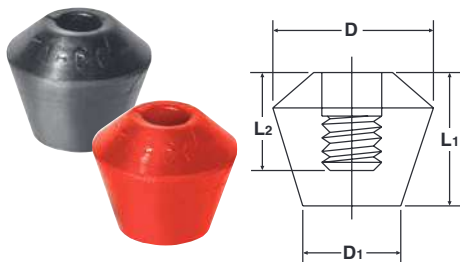

Part No.	D	D1	L1	L2	For Spindle Diameter	Color
215219					1/4-20	Black
215219-M	[0.79] 20	[0.50] 12,7	[0.69] 17,5	[0.50] 12,7	M6 x 1.0	Red
225219					5/16-18	Black
225219-M					M8 x 1.25	Red
235219	[0.81] 20,5	[0.63] 16	[0.88] 22,3	[0.63] 16	3/8-16	Black
235219-M					M10 x 1.5	Red

### Polyurethane Caps – Cone-tip

- Cone tip, internally threaded
- Hardness: 80 Shore A
- Temperature range:  
-70°C to 95°C [-90°F to 200°F]

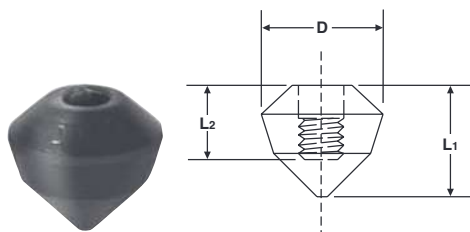

Part No.	D	L1	L2	For Spindle Diameter
215319				1/4
225319	[0.81] 20,5	[0.75] 19,1	[0.50] 12,7	5/16
235319		[0.94] 23,9	[0.63] 16	3/8

# BOLT RETAINERS, WASHERS

Manual Clamping Accessories | Technical Information | Dimensions

## Bolt Retainers –

- For use with clamps featuring U-bar and open bar clamping arms

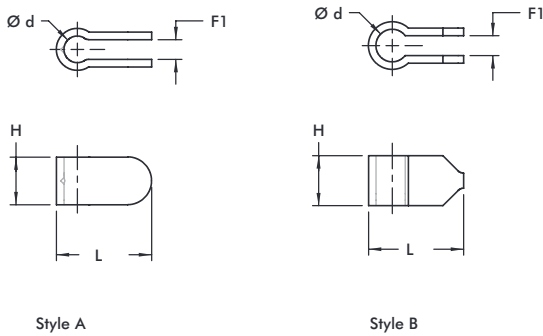

Part No.	L	H	Ød	F1	For Spindle Diameter	Style
207105	[1.23] 31,3	[0.63] 16	[0.34] 8,7	[0.28] 7,1	M8 or 5/16	A
207107	[1.41] 35,4		[0.32] 8,2	[0.24] 6		B
207105-M	[1.26] 32					
210114	[1.50] 38,1	[0.75] 19,1	[0.53] 13,5	[0.31] 8	M10 or 3/8	A
210114-M	[1.49] 38	[0.78] 20	[0.51] 13			B
110122	[1.88] 47,8	[1.00] 25,4	[0.57] 14,4	[0.38] 9,5	M12 or 1/2	A
247110	[1.63] 41,4	[0.88] 22,3	[0.56] 14,2	[0.38] 9,7		B
247110-M	[1.61] 41	[0.87] 22,2	[0.57] 14,4			A
250121	[1.88] 47,8	[1.00] 25,4	[0.64] 16,3			A
205105	[1.25] 31,8	[0.50] 12,7	[0.28] 7,2	[0.20] 5,1	M6 or 1/4	A
2002115-E	[0.97] 24,6		[0.26] 6,6	[0.23] 5,8		M8 or 5/16
2007115-E	[1.26] 32	[0.75] 19,1	[0.34] 8,6			
2010115-E	[1.58] 40,1	[1.13] 28,7	[0.41] 10,4	[0.32] 8,1	M10 or 3/8	

## Flanged Washers –

- For use with clamps featuring U-bar and open bar clamping arms
- Zinc plated

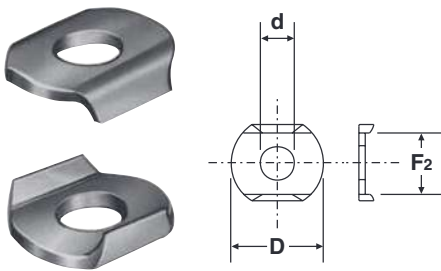

Part No.	ØD	Ød	F2	For Spindle Diameter
105106	[0.44] 11,2	[0.17] 4,3	[0.33] 8,3	M4 or #8
102111	[0.56] 14,2	[0.20] 5,1	[0.38] 9,6	M5 or #10
215105	[0.69] 17,5	[0.26] 6,7	[0.50] 12,7	M6 or 1/4
507107	[0.88] 22,4	[0.33] 8,4	[0.59] 15	M8 or 5/16
235106	[1.00] 25,4	[0.41] 10,5	[0.75] 19,1	M10 or 3/8
247109	[1.26] 32	[0.53] 13,5	[0.91] 23,2	M12 or 1/2
267102	[1.44] 36,5	[0.66] 16,8	[1.03] 26,2	M16 or 5/8

## Flanged Washers-Stainless Steel

- For use with clamps featuring U-bar and open bar clamping arms

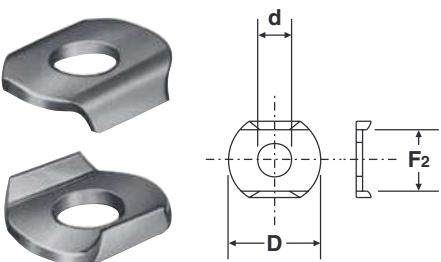

Part No.	ØD	Ød	F2	For Spindle Diameter
105906	[0.44] 11,2	[0.17] 4,3	[0.33] 8,3	M4 or #8
102911	[0.56] 14,2	[0.20] 5,1	[0.38] 9,6	M5 or #10
215905	[0.69] 17,5	[0.26] 6,7	[0.50] 12,7	M6 or 1/4
507907	[0.88] 22,4	[0.33] 8,4	[0.60] 15,2	M8 or 5/16
235906	[1.00] 25,4	[0.41] 10,5	[0.75] 19,1	M10 or 3/8

# ADAPTERS & EXTENSIONS

## Manual Clamping Accessories | Product Overview

### Features:

- Provides flexible adjustment of length and height
- Mounts to manual clamp models that feature open clamping arms
- Lightweight aluminum

### Application Areas:

- Checking fixtures
- Areas requiring multiple clamping points

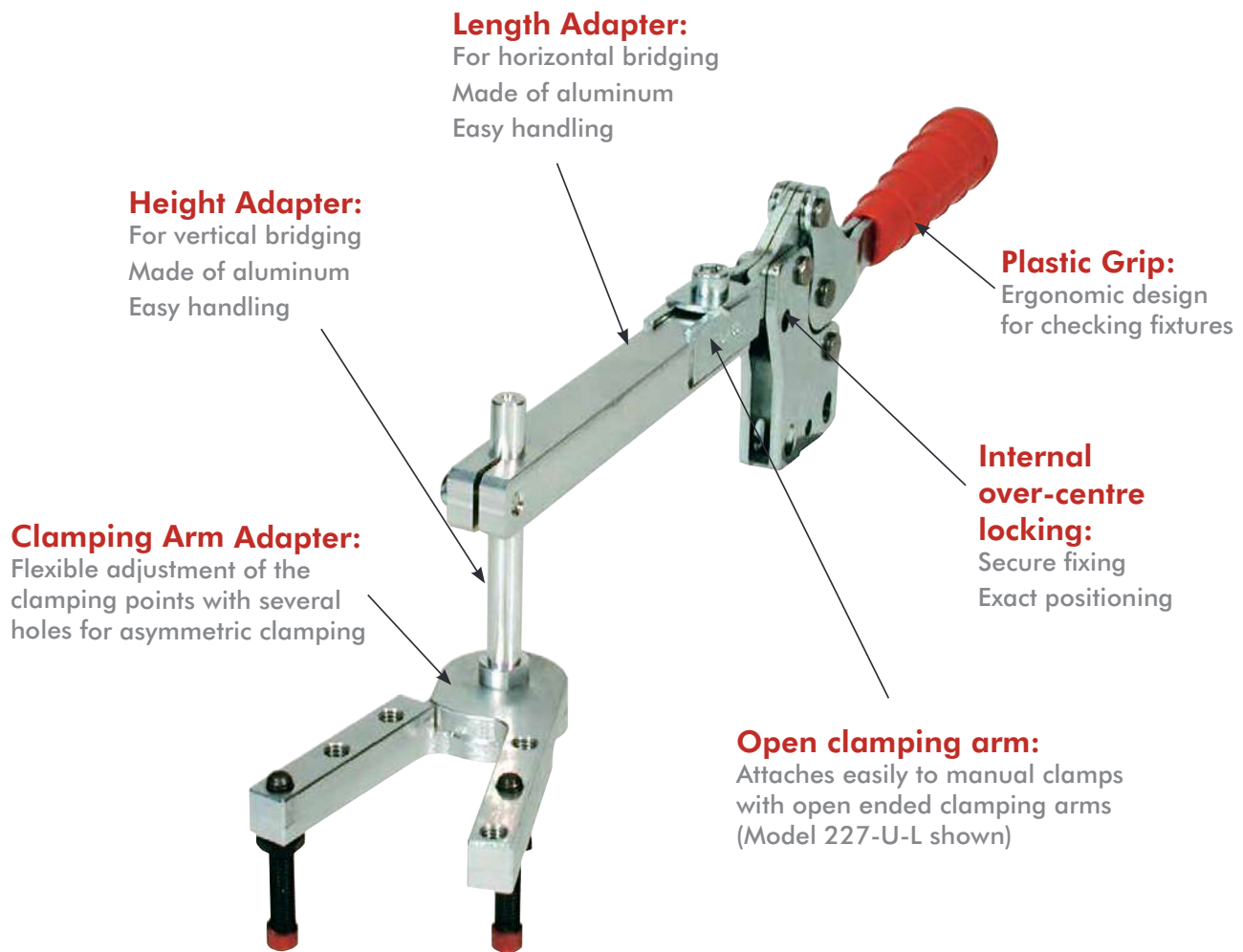

Also available in black

### Adjustment Spindles:

For Checking Fixtures  
Small head-diameter  
No interference during the checking process

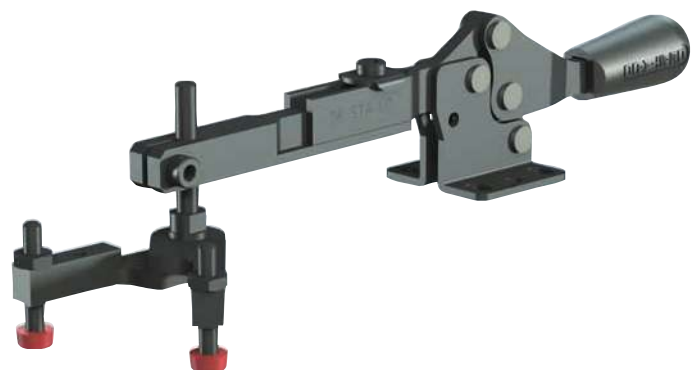



# ADAPTERS & EXTENSIONS

## Manual Clamping Accessories | Dimensions

### Length Adapter

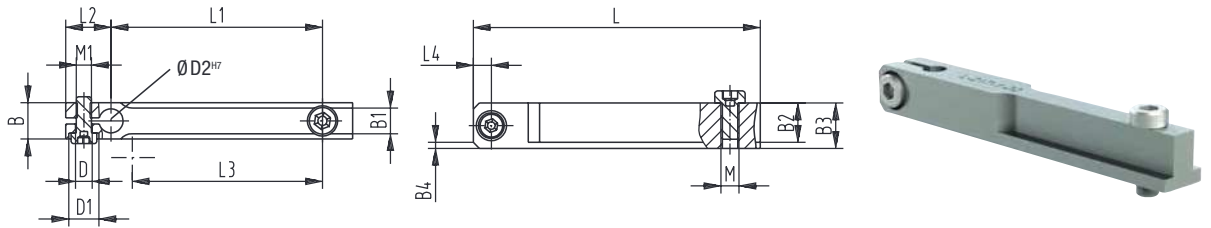

Model no.	Length adapter	B	B1	+0, B2	B3	B4	DØ	D1 Ø	D2 <sup>H7</sup>	L	L1±0,2	L2	L3	L4	M	M1
213-U-L / 213-UB-L	L-213-1-01 ⓘ	[0.39]	[0.22]	[0.31]	[0.39]	2x	[0.22]	--		[1.97]	[1.18]					
2013-U / 2013-UB	L-213-1-02 ⓘ	10	5,5	8	10	45°	5,5			[3.54]	[2.76]	[0.47]	[0.79]	[0.20]	M4	M5
2013-UR / 2013-UBR										90	70	12	20	5		
202-U-L / 202-UB-L	L-217-1-01 ⓘ								[0.24]	[2.17]	[1.18]		[1.30]			
217-U-L / 217-UB-L									6	55	30		33			
2002-U-L / 2002-UB-L	L-217-1-02 ⓘ		[0.26]	[0.35]	[0.47]	2x	[0.22]			[3.74]	[2.76]				M5	M5
2017-U / 2017-UB	L-217-1-03 ⓘ		6,5	9	12	45°	5,5			95	70		[1.89]			
2017-UR / 2017-UBR										[5.31]	[4.33]		48			
2017-UR / 2017-UBR										135	110					
207-U-L / 207-UB-L	L-227-1-01 ⓘ	[0.47]						[0.39]		[2.17]	[1.18]	[0.59]	[1.30]	[0.24]		
227-U-L / 227-UB-L	L-227-1-02 ⓘ	12						10		55	30	15	33	6		
2007-U-LS / 2007-U-LS	L-227-1-03 ⓘ		[0.33]	[0.51]	[0.59]	2x	[0.22]			[3.74]	[2.76]				M6	M5
2027-U / 2027-UB	L-227-1-04 ⓘ		8,5	13	15	45°	5,5		[0.31]	95	70		[2.87]			
2027-UR / 2027-UBR									8	[5.31]	[4.33]		73			
2027-UR / 2027-UBR										[6.89]	[5.91]					
2027-UR / 2027-UBR										175	150					

ⓘ Available upon request.

Also available in Black. Add **-BLK** to part number.

### Height Adapter

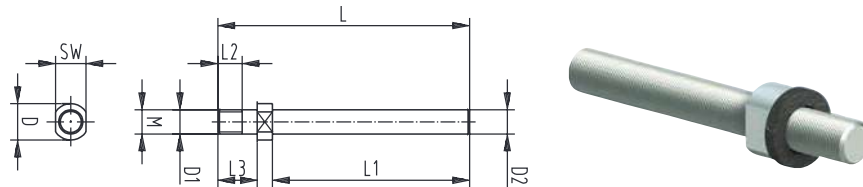

Model no.	Height adapter	DØ	D1 Ø <sub>H7</sub>	D2 <sub>H7</sub>	L	L1	L2	L3	SW	M
213-U-L / 213-UB-L	L-213-2-01 ⓘ		[0.20]	[0.24]	[2.05]	[1.38]				
2013-U / 2013-UB	L-213-2-02 ⓘ		5	6	52	35				M5
2013-UR / 2013-UBR					[3.23]	[2.56]				
2013-UR / 2013-UBR					82	65				
202-U-L / 202-UB-L	L-217-2-01 ⓘ	[0.39]			[2.05]	[1.38]		[0.47]	[0.31]	
217-U-L / 217-UB-L		10			52	35		12	8	
2002-U-LS / 2002-UB-LS	L-217-2-02 ⓘ		[0.24]	[0.24]	[3.23]	[2.56]	[0.31]			M6
2017-U / 2017-UB			6	6	82	65	8			
2017-UR / 2017-UBR										
207-U-L / 207-UB-L	L-227-2-01 ⓘ				[2.09]	[1.38]				
227-U-L / 227-UB-L					53	35				
2007-U-LS / 2007-U-LS	L-227-2-02 ⓘ	[0.31]	[0.31]	[0.31]	[3.23]	[2.56]		[0.51]	[0.39]	M8
2027-U / 2027-UB		8	8	88	82	65		13	10	
2027-UR / 2027-UBR										

ⓘ Available upon request.

Also available in Black. Add **-BLK** to part number.



# ADAPTERS & EXTENSIONS

## Manual Clamping Accessories | Dimensions

### Clamping Arm Adapter

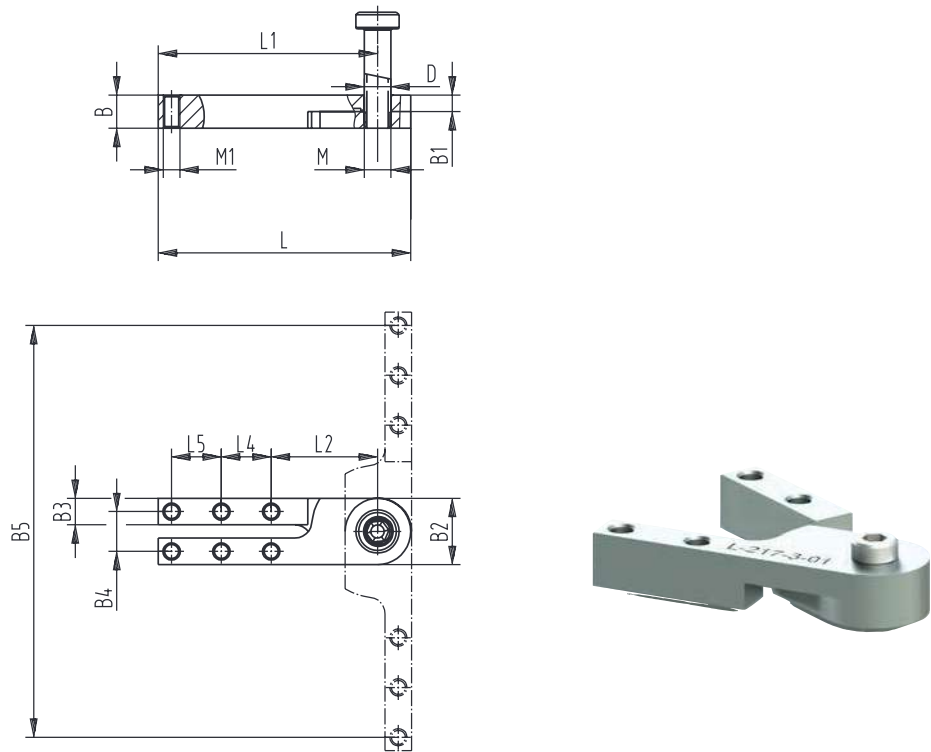

Model no.	Clamping arm adapter	B	B1	B2	B3	B4	B5	DØ <sub>H7</sub>	L	L1	L2	L4	L5	L6	M	M1
213-U-L / 213-UB-L 2013-U / 2013-UB 2013-UR / 2013-UBR	L-213-3-01 ⓘ							[0.20] 5					-		M5	M5
202-U-L / 202-UB-L 217-U-L / 217-UB-L 2002-U-LS / 2002-UB-LS 2017-U / 2017-UB 2017-UR / 2017-UBR	L-217-3-01 ⓘ	[0.39] 10	[0.20] 5	[0.79] 20	[0.31] 8	[0.47] 12	[3.70] 94	[0.24] 6	[2.40] 61	[2.01] 51					M6	M5
207-U-L / 207-UB-L 227-U-L / 227-UB-L 2007-U-LS / 2007-UB-LS 2027-U / 2027-UB 2027-UR / 2027-UBR	L-227-3-01 ⓘ						4.88] 124	[0.31] 8	[2.99] 76	[2.60] 66			[0.59] 15		M8	M5

ⓘ Available upon request.

Also available in Black. Add **-BLK** to part number.

# ADAPTERS & EXTENSIONS

## Manual Clamping Accessories | Dimensions

### Arm Extension:

- Easily cut to length
- Drilled & tapped for spindle attachment

Note: adding arm extension will reduce the clamp's holding capacity. Refer to Technical Appendix for details

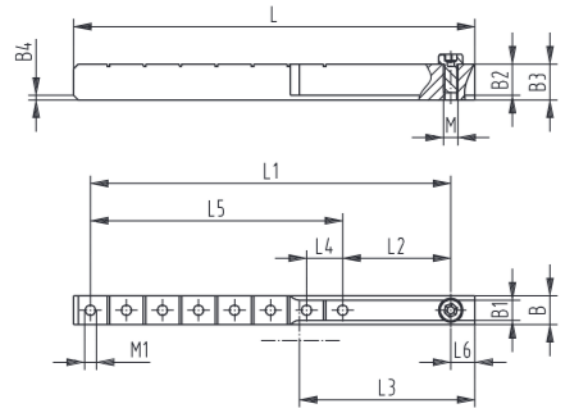

Model no.	Extension link	B	B1 +0, -1	B2	B3	B4	L ±0,2	L1	L2	L3	L4	L5	L6	M	M1
213-U-L / 213-UB-L 2013-U / 2013-UB 2013-UR / 2013-UBR	L-213-4-01 ⓘ	[0.39] 10	[0.22] 5,5	[0.31] 8	[0.39] 10	2x 45°	[3.35] 85	[2.76] 70	[0.87] 22	[0.79] 20	[0.47] 12	[1.89] 48	[0.31] 8	M4	M5
202-U-L / 202-UB-L 217-U-L / 217-UB-L 2002-U-LS / 2002-UB-LS 2017-U / 2017-UB 2017-UR / 2017-UBR	L-217-4-01 ⓘ	[0.47] 12	[0.26] 6,5	[0.35] 9	[0.47] 12	2x 45°	[5.00] 127	[4.33] 110	[1.38] 35	[1.89] 48	[0.59] 15	[2.95] 75	[0.39] 10	M5	M5
207-U-L / 207-UB-L 227-U-L / 227-UB-L 2007-U-LS / 2007-UB-LS 2027-U / 2027-UB 2027-UR / 2027-UBR	L-227-4-01 ⓘ	[0.33] 8,5	[0.51] 13	[0.59] 15	2x 45°	[6.57] 167	[5.91] 150	[1.77] 45	[2.87] 73	[4.13] 105	[0.39] 10	M6	M5		

ⓘ Available upon request. Also available in Black. Add -BLK to part number.

### Cross Arm Set

- 1 x cross arm
- 2 x adjustment spindles with neoprene thrust pads vulcanized, resin-free, inc.
- 2 x fastening nuts
- 4 x flange washers
- 1 x screw incl. 1 x fastening nut, self-locking

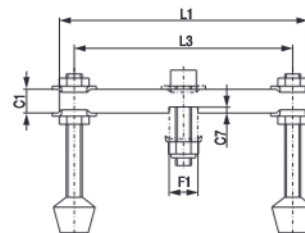

Model no.	For Models with U Arms	C1	C7	F	F1	L1	L3	Adjustable Spindles
207426-Q	207, 225, 227	[0.47] 12	[0.12] 3	[0.31] 35	[0.57] 14,5	[4.92] 125	[4.33] 110	507208-M
210440-Q	210, 235, 237	[0.63] 16	[0.16] 4	[0.43] 11	[0.75] 19	[5.87] 149	[5.12] 130	240208-M